

Miscelatori **termostatici** incasso
*Concealed **thermostatic** mixers*
Eingebaute **thermostatische** Mischbatterie

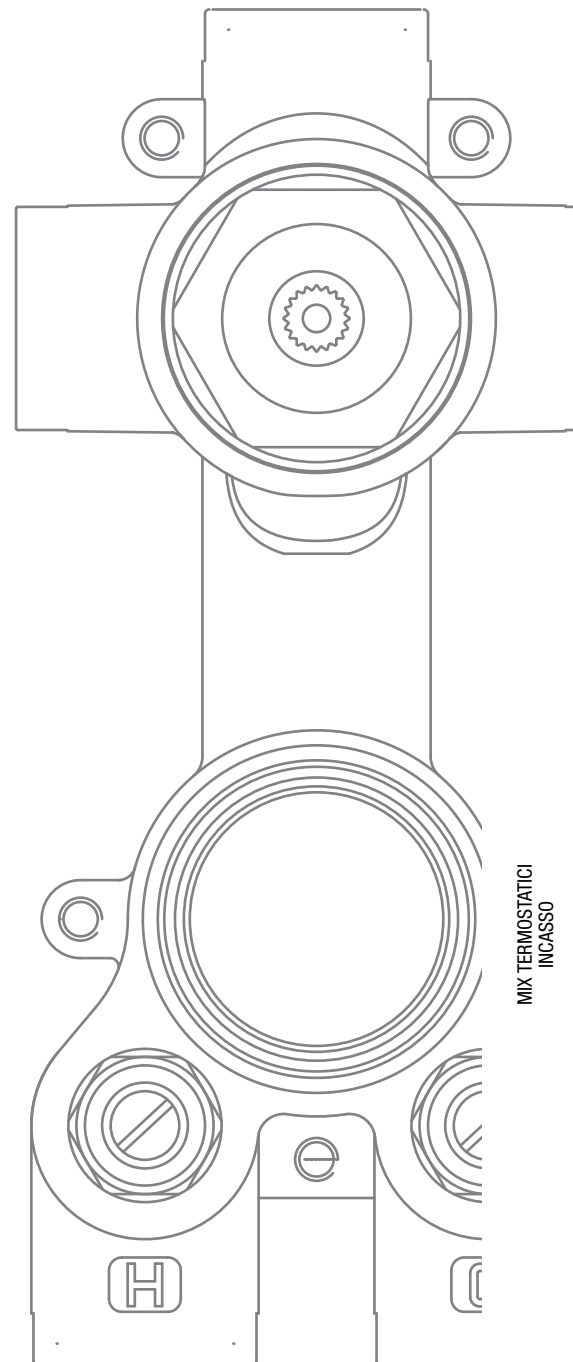

MIX TERMOSTATICI
INCASSO

Miscelatore termostatico doccia incasso con deviatore

Concealed thermostatic shower mixer with diverter

Eingebaute thermostatische Mischbatterie für Duschen mit einem Umstellventil

38°

DZR
Available

pressione - pressure - Druck **3 bar**

65.00°C 10.57 l/m

38.67°C 24.33 l/m

18.05°C 13.76 l/m

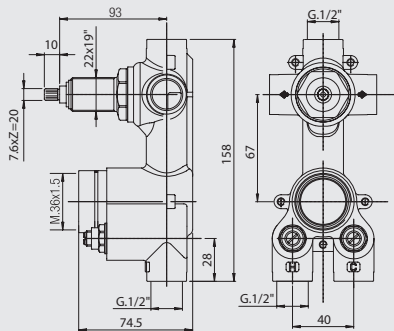

Gebis
water control

Piastrine idonee - Appropriate plates - Passende Platten

Art. 8014 CA

Piastra 115x200 mm
anelli ottone cromato
*Plate 115x200 mm
chrome-plated brass rings*
Platte aus Chrom 115x200 mm
Ringe aus verchromten Messing

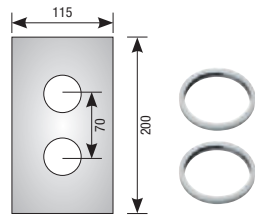

Art. 8015 CA

Piastra 130x230 mm
anelli ottone cromato
*Plate 130x230 mm
chrome-plated brass rings*
Platte aus Chrom 130x230 mm
Ringe aus verchromten Messing

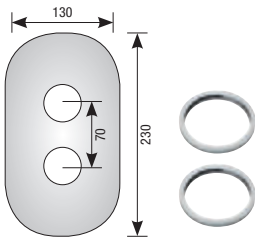

Art. 8016 CA

Piastra 115x200 mm
anelli ottone cromato
*Plate 115x200 mm
chrome-plated brass rings*
Platte aus Chrom 115x200 mm
Ringe aus verchromten Messing

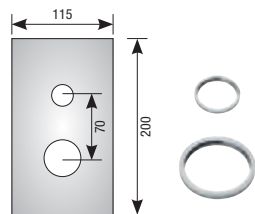

Art. 8017 CA

Piastra 130x230 mm
anelli ottone cromato
*Plate 130x230 mm
chrome-plated brass rings*
Platte aus Chrom 130x230 mm
Ringe aus verchromten Messing

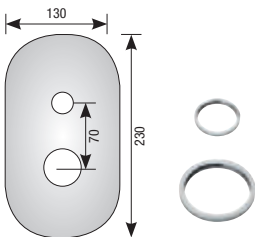

1 way



Art. 8000A1

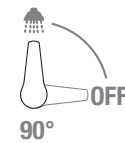

2 exits



Art. 8000A2

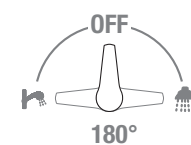

3 exits



Art. 8000A3

Art. 8000A3/3

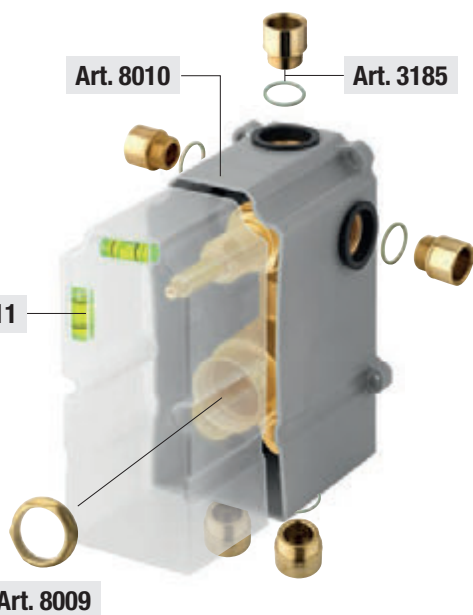
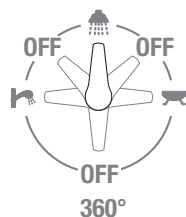
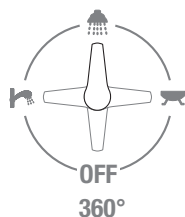

Art. 8012
Anello ottone cromato
Chrome-plated brass ring
Ring aus verchromten Messing

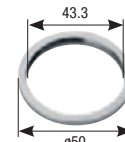

Art. 00040
Anello fissaggio piastra per deviatore
Plate fixing ring - diverter
Plattenbefestigungsring für Umstellventil



Art. 8002
Anello per cartuccia termostatica
Ring for thermostatic cartridge
Ring für Thermostatkartusche

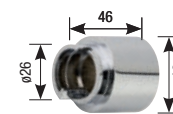

Art. 8003
Anello per deviatore
Ring for diverter
Ring für Umstellventil

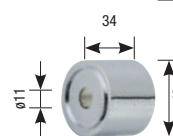

Art. 8007
Anello per art. 8003
Ring for art. 8003
Ring für 8003



Art. 00120
Maniglia deviatore
Diverter handle
Umstellgriff

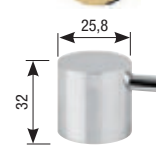

Art. 00080
Coprifiletto deviatore cromato
Diverter cover thread
Verchromte Gewindeabdeckung Umstellventil

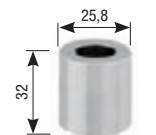

Art. 8013
Membrana isolante
Insulating membrane
Isolierungsmembran

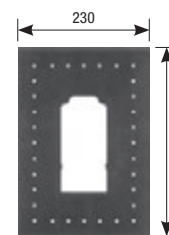

Art. 8010
Scatola di assemblaggio
System box
Multipurpose assembling box
System box
Montagegehäuse
System box



Art. 8011
Coperchio scatola
Box cover
Gehäuseabdeckung



Art. 3185
Prolunga G.1/2"
Extension G.1/2"
Verlängerung mit 1/2"-Drehung



Art. 3181G1/2
Guarnizione G.1/2"
Gasket G.1/2"
Dichtung mit 1/2"-Drehung



Art. 8009
Ghiera serraggio
Ring nut
Gewindeverschraubung



MIX THERMOSTATIC
INCASSO

Miscelatore **termostatico doccia** incasso
Concealed **thermostatic shower mixer**
 Eingebaute **thermostatische** Mischbatterie für **Duschen**

38°



pressione - *pressure* - Druck **3 bar**

66.73°C 18.63 l/m

37.05°C 44.83 l/m

15.66°C 26.20 l/m

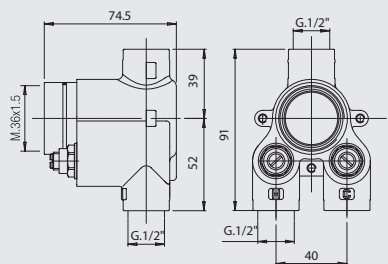

Art. 8001A



Art. 8002
 Anello per cartuccia termostatica
Ring for thermostatic cartridge
 Ring für Thermostatkartusche

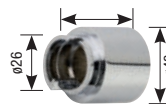

Art. 8009
 Ghiera serraggio
 Ring nut
 Gewindeverschraubung



Scatola incasso per miscelatore incasso **doccia termostatico**

Box for concealed **thermostatic shower mixer**

Gehäuse für eine **thermostatische** Mischbatterie für **Duschen**

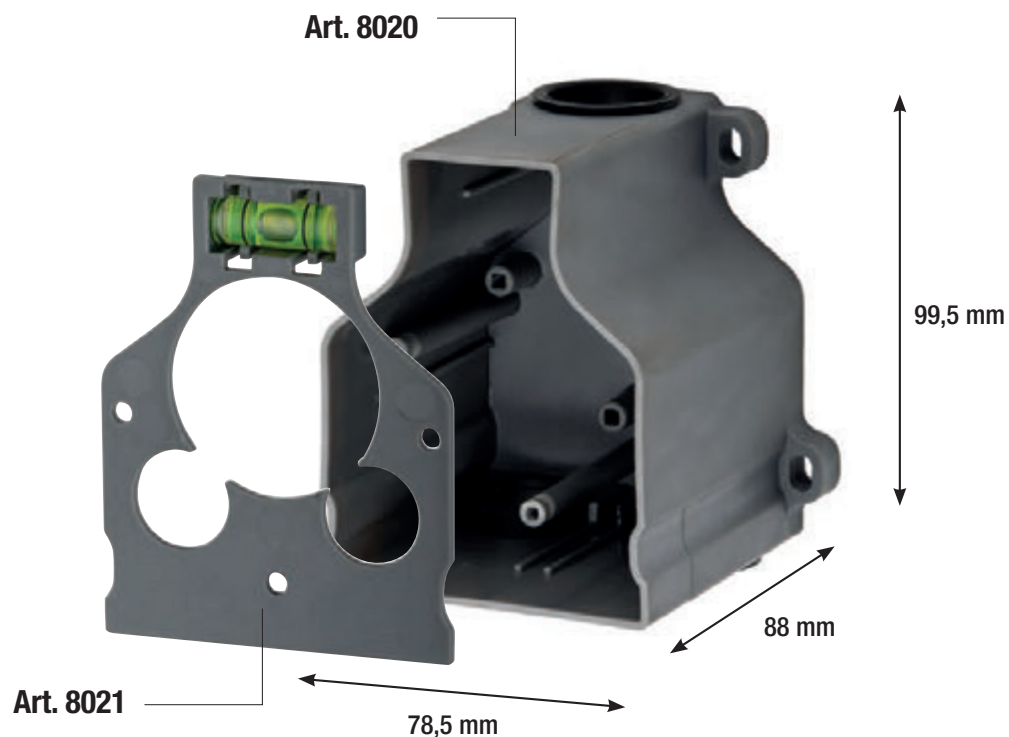

Art. TH ROS
Rosoni h 2 mm
Rosas h 2 mm
Rosas h 2 mm

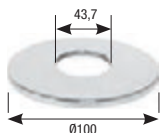

Art. MAN TH GB
Maniglia termostatico
Thermostatic handle
Thermostatgriff

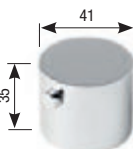

Art. 8001 KIT PRO
Prolunga termostatico
Thermostatic Extension
Thermostat-Erweiterung



Art. 3185
Prolunga G.1/2"
Extension G.1/2"
Verlängerung mit 1/2"-Drehung



Art. 3181G1/2
Guarnizione G.1/2"
Gasket G.1/2"
Dichtung mit 1/2"-Drehung



Miscelatore termostatico doccia incasso

Concealed thermostatic shower mixer

Eingebaute thermostatische Mischbatterie für Duschen

38°

2/3 exits

Ø35

DZR Available

Diagramma di portata (uscita libera)
Flow diagram (free exit)
Diagramm der Durchflussleistung (freier Ausgang)

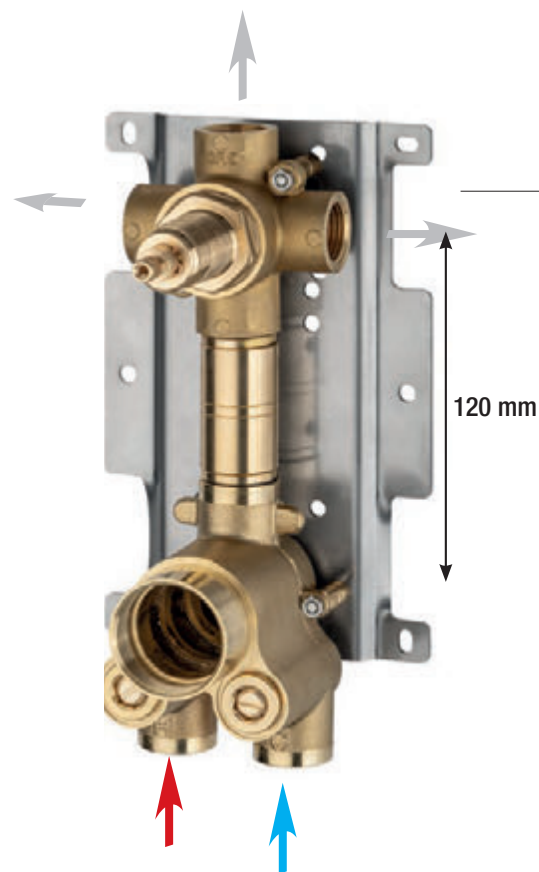
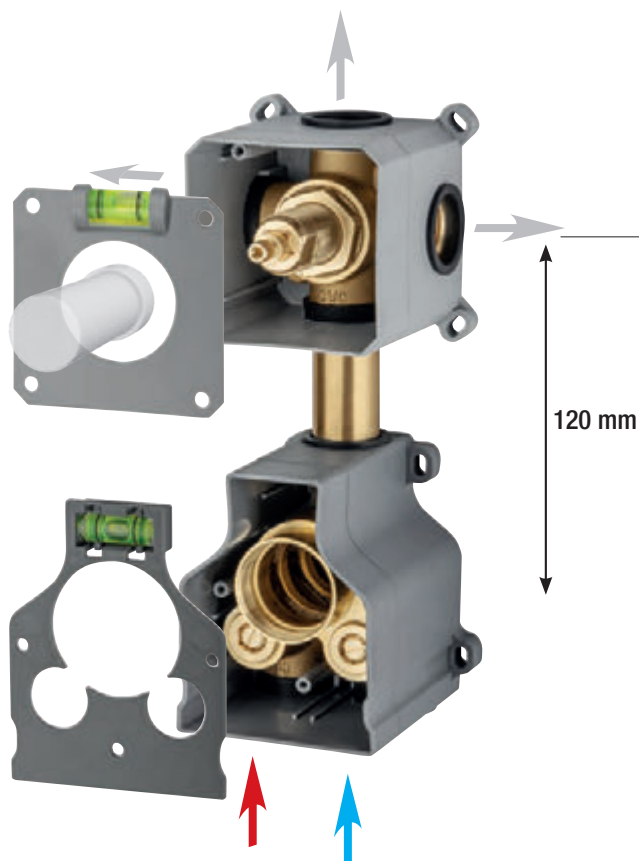
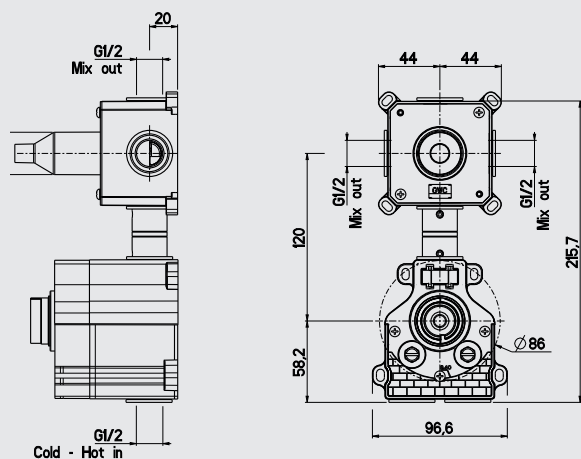
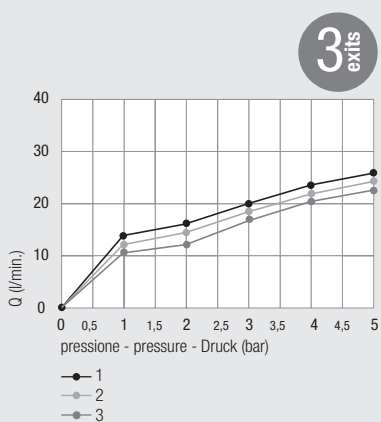
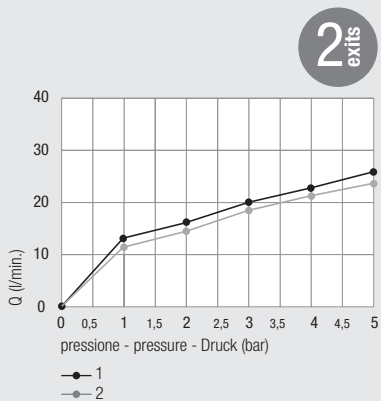

con deviatore **ceramico**
with **ceramic diverter**
Keramik-Umstellventil



Art. 2003GRFA



Art. 2000FS



Art. 2001FS

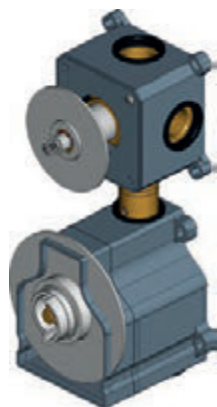

INSTALLATION next page

con **scatola** - with **box** - mit **Unterputzdose**

Art. 2403C01



Art. 2403D01



Art. 2403B01

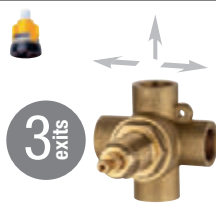

con **piastra** - with **plate** - mit **Platte**

Art. 2403K01

Art. 2403L01

Art. 2403J01

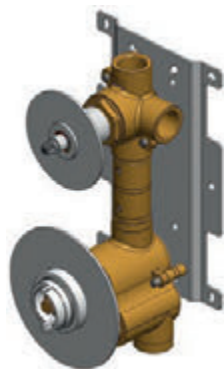

per **termostatico**
for **thermostatic**
für **thermostatische**

Art. 8020

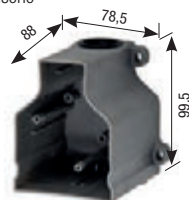

Art. 8021



Art. 8002

Anello per cartuccia termostatica
Ring for thermostatic cartridge
Ring für Thermostatkartusche

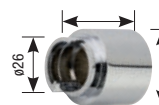

Art. 8009

Ghiera serraggio
Ring nut
Gewindeverschraubung



Art. MAN TH GB

Maniglia termostatico
Thermostatic handle
Thermostatgriff

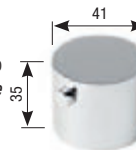

Art. TH ROS

Rosoni h 2 mm
Rosas h 2 mm
Rosas h 2 mm

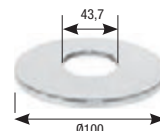

Art. 8001 KIT PRO

Prolunga termostatico
Thermostatic Extension
Thermostat-Erweiterung



per **deviatore**
for **diverter**
für **Umsteller**

Art. 3190

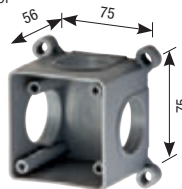

Art. 3189



Art. PR22/19

Protezione coprifiello
Thread protection
Gewindeabdeckungsschutz

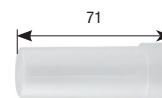

Art. 00120

Maniglia deviatore
Diverter handle
Umstellgriff

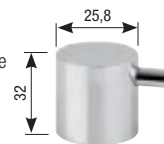

Art. 00080

Coprifiello deviatore cromato
Diverter cover thread
Verchromte
Gewindeabdeckung
Umstellventil

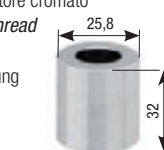

Art. 00080ROS

Rosoni h 2 mm
Rosas h 2 mm
Rosas h 2 mm

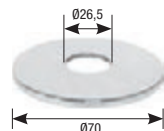

Art. 640

Prolunga deviatore
Diverter extension
Verlängerung
Umstellventil

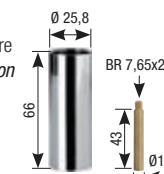

Art. 640A

Prolunga deviatore
Diverter extension
Verlängerung
Umstellventil

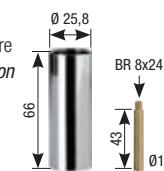

Art. 3185

Prolunga G.1/2"
Extension G.1/2"
Verlängerung mit 1/2"-Drehung



Art. 3181G1/2

Guarnizione G.1/2"
Gasket G.1/2"
Dichtung mit 1/2"-Drehung



Art. STAFF

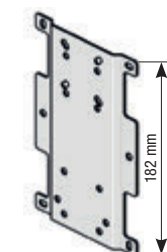

Installazione e manutenzione
Installation and maintenance
Installation und wartung

Art. 2403-c01/D01/B01

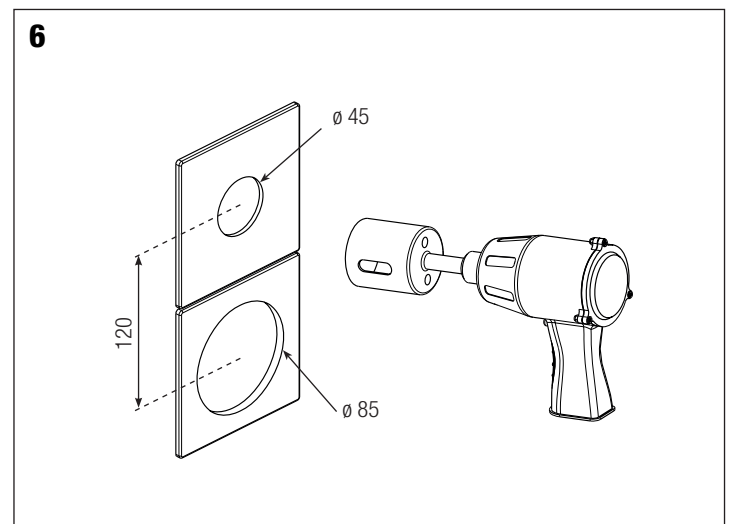
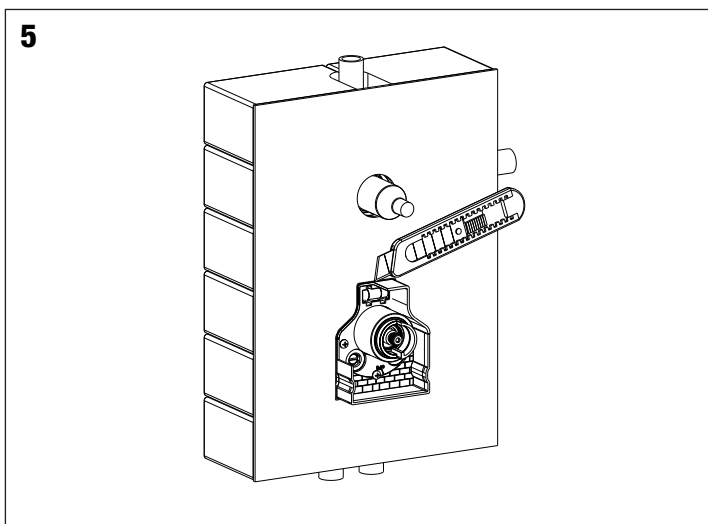
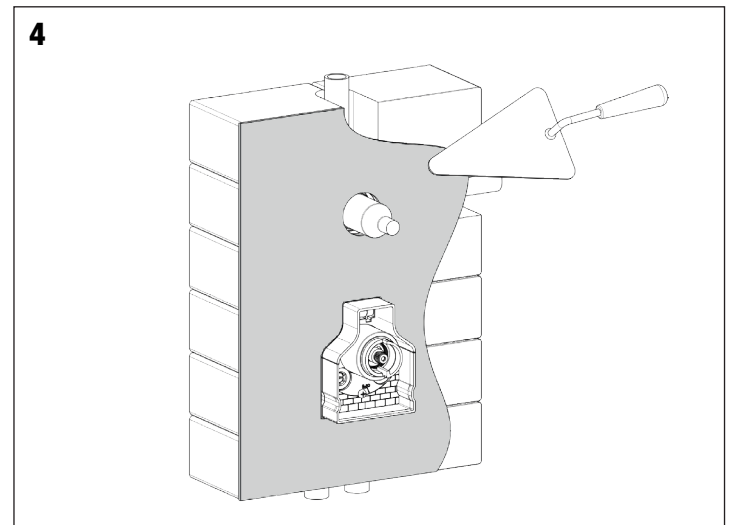
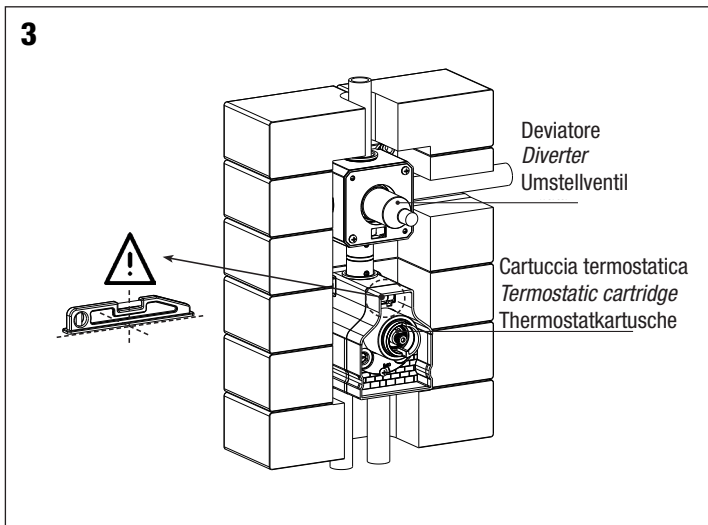
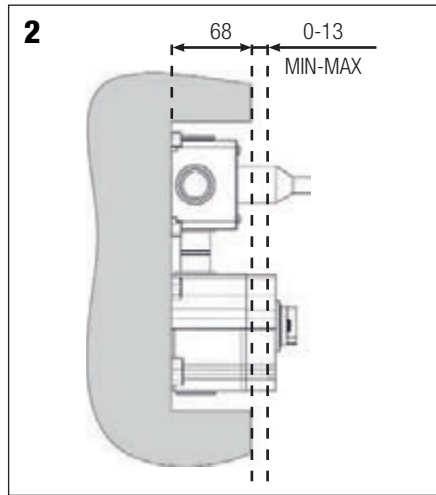
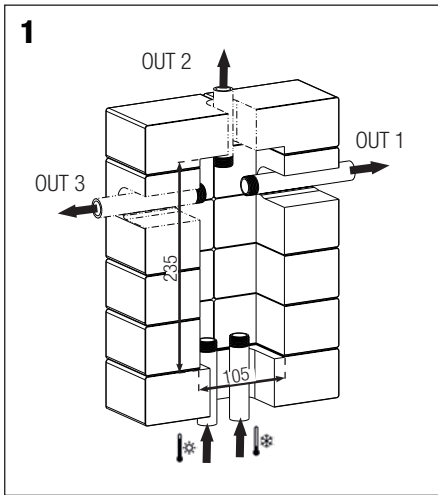
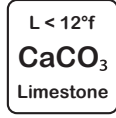
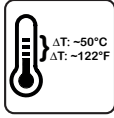
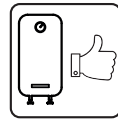
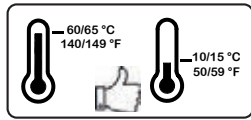
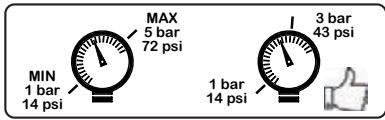

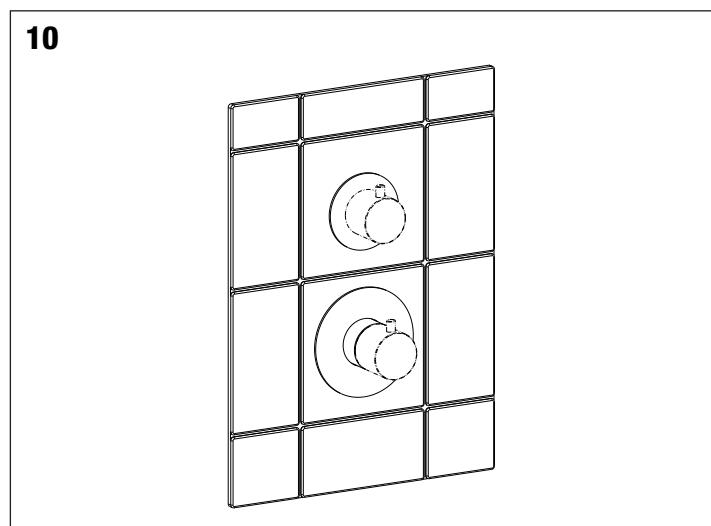
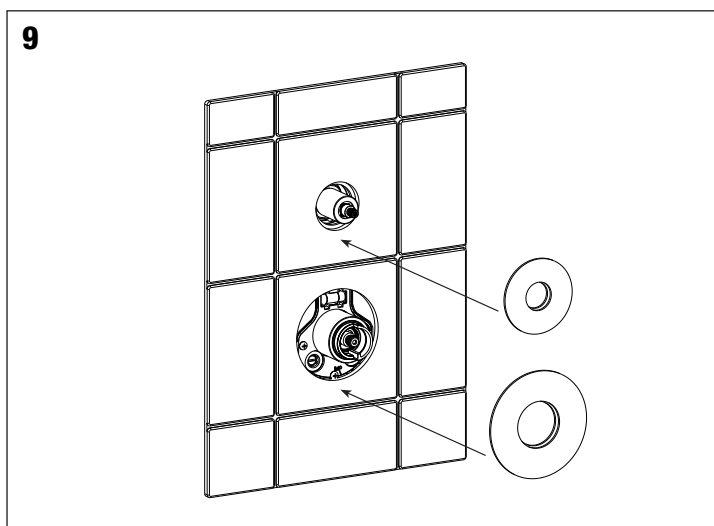
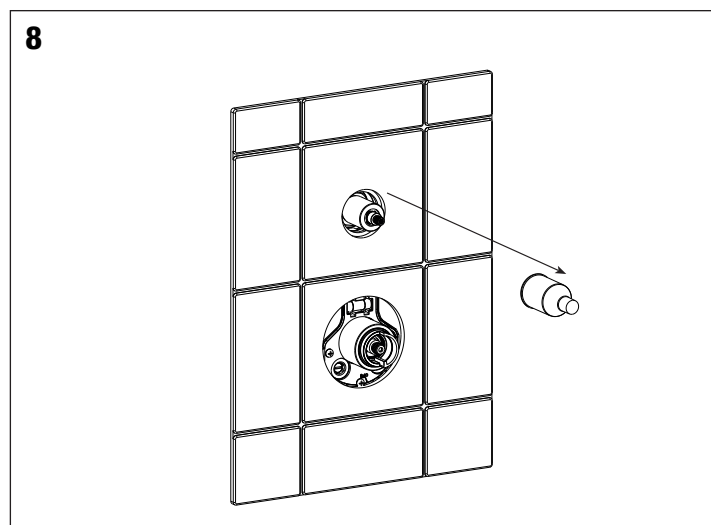
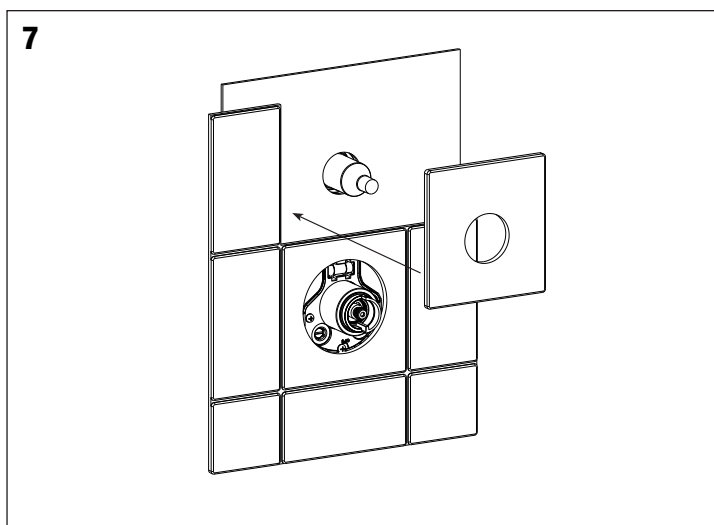

Sostituzione delle cartucce - Cartridges replacement

Prima di procedere alla manutenzione o alla sostituzione, chiudere l'acqua della rete idrica.

Turn off the mains water before carrying out maintenance or replacement operations.

Vor dem Austausch oder Wartungsarbeiten das Wasser am Haupthahn abstellen.

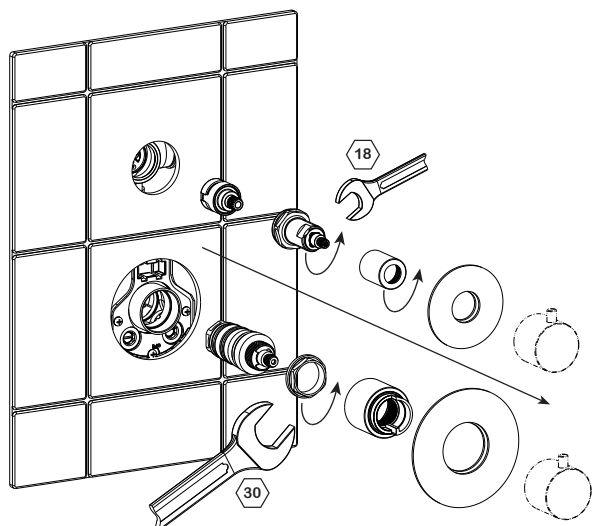

Pulizia filtri / Sostituzione valvole non ritorno
Filters cleaning / Check valves replacement

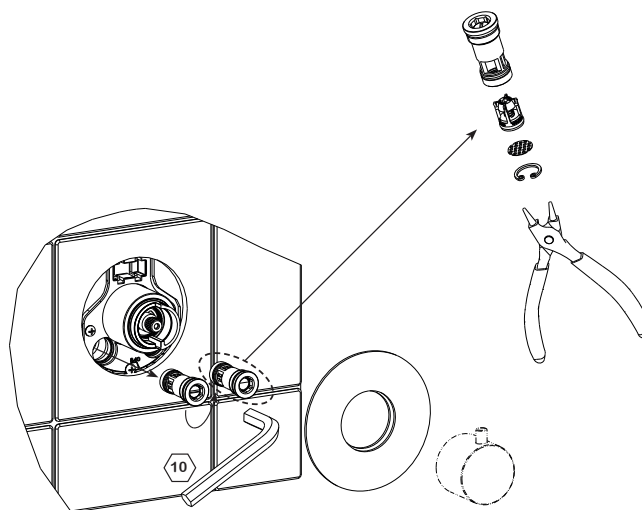

Miscelatore termostatico doccia incasso

Concealed *thermostatic shower mixer*

Eingebaute *thermostatische* Mischbatterie für **Duschen**

con deviatore **click-clack**
with click-clack diverter
 mit **click-clack**



DZR
Available

Diagramma di portata
(uscita libera)
*Flow diagram
(free exit)*
 Diagramm der
Durchflussleistung
(freier Ausgang)

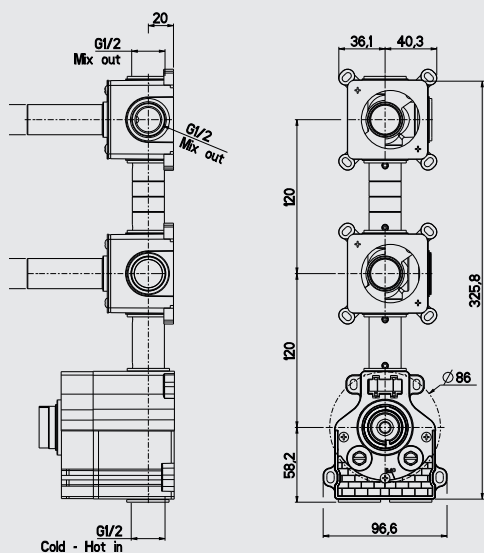
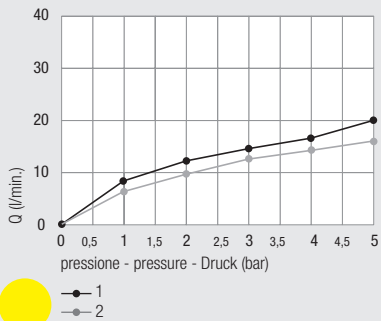

Design



Art.Q
 Versione quadrata
Square version
 Quadratische Ausführung

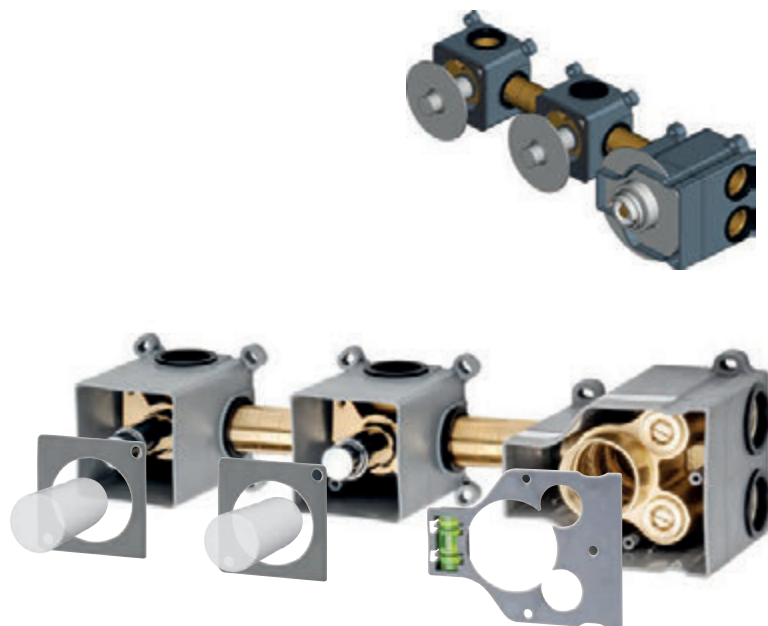

INSTALLATION next page

con **scatola** - *with box* - mit **Unterputzdose**

Art. GB2403-A01

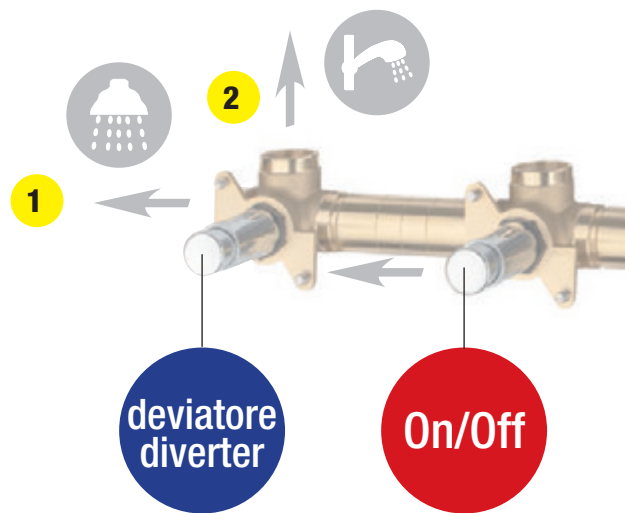

38°

2 exits

Ø 35

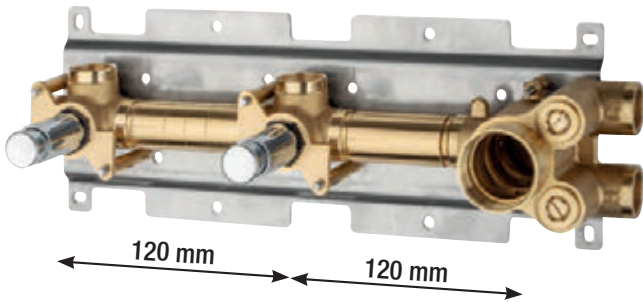
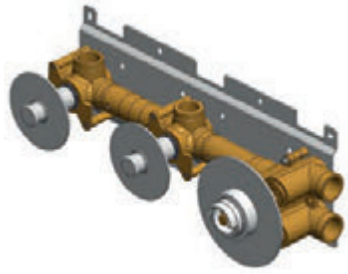

con piastra - with plate - mit Platte

Art. GB2403-I01



per termostatico
for thermostatic
für thermostatische

Art. 8020

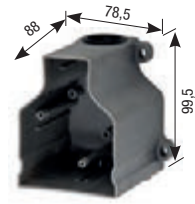

Art. 8021



Art. 8002

Anello per cartuccia termostatica
Ring for thermostatic cartridge
Ring für Thermostatkartusche

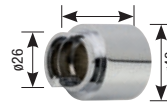

Art. 8009

Ghiera serraggio
Ring nut
Gewindeverschraubung



Art. MAN TH GB

Maniglia termostatico
Thermostatic handle
Thermostatgriff

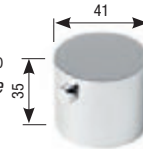

Art. TH ROS

Rosoni h 2 mm
Rosas h 2 mm
Rosas h 2 mm

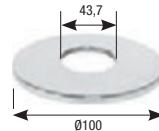

Art. 8001 KIT PRO

Prolunga termostatico
Thermostatic Extension
Thermostat-Erweiterung



Art. 3185

Prolunga G. 1/2"
Extension G. 1/2"
Verlängerung mit 1/2"-Drehung



Art. 3181G1/2

Guarnizione G. 1/2"
Gasket G. 1/2"
Dichtung mit 1/2"-Drehung



per deviatore
for diverter
für Umsteller

Art. 3195

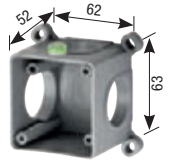

Art. 3196



Art. PR20K

Protezione in plastica
Plastic protection
Kunststoffschutzeinrichtung



Art. 1502ROS

Rosoni h 2 mm
Rosas h 2 mm
Rosas h 2 mm

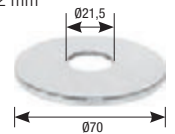

STAFF1

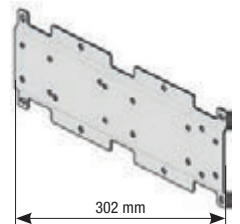

MIX THERMOSTATICI
INCASSO

Installazione e manutenzione
Installation and maintenance
Installation und wartung

Art. 2403-A01

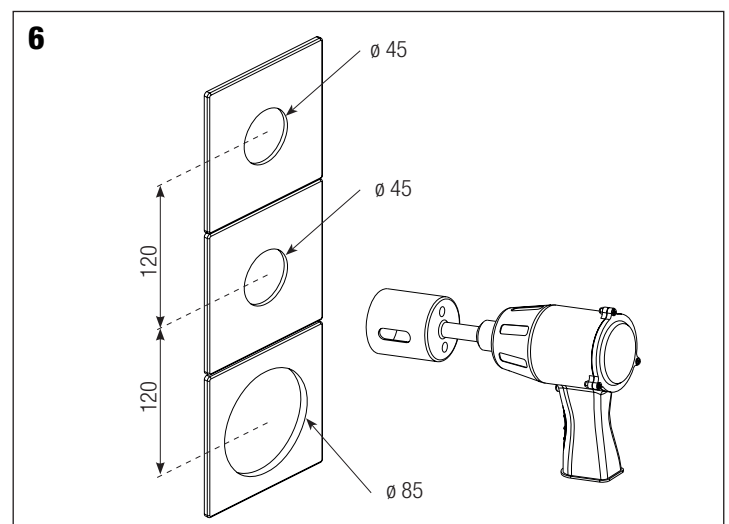
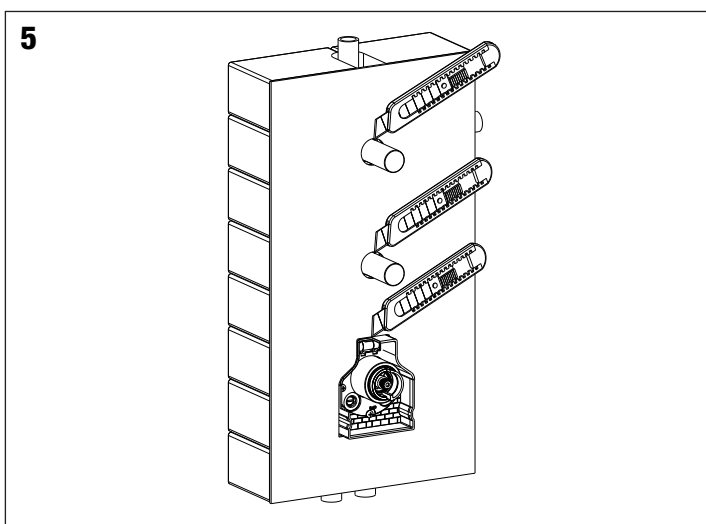
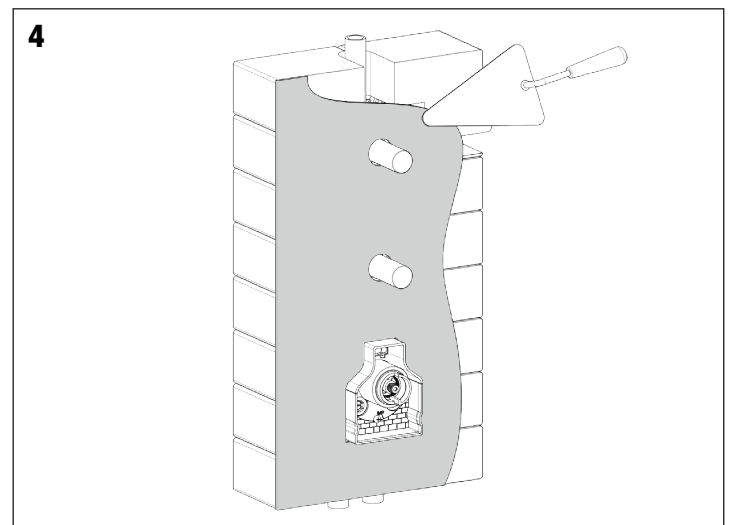
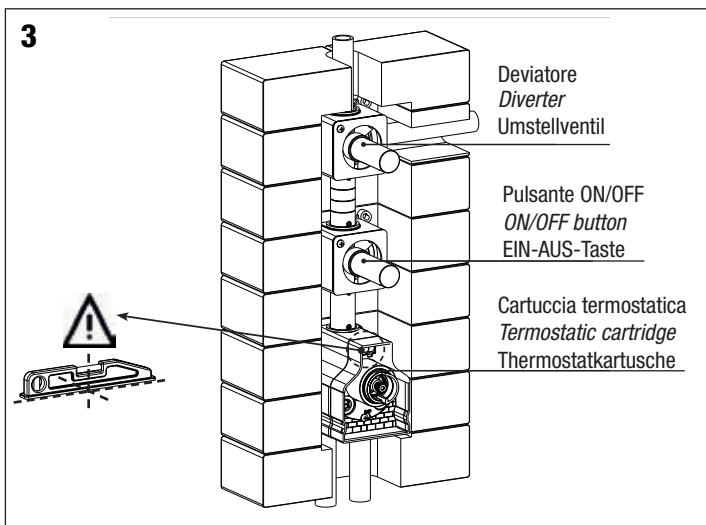
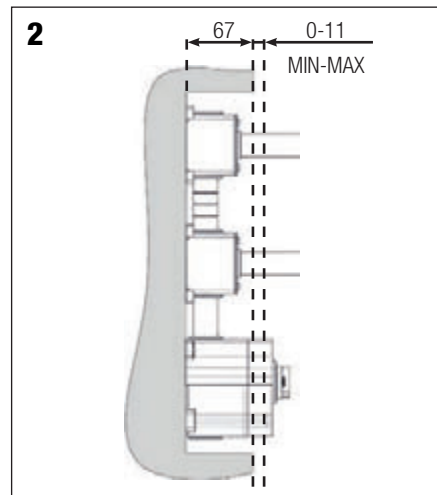
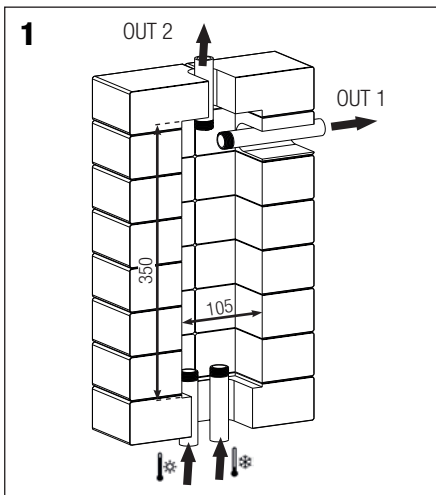
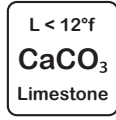
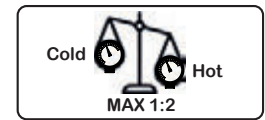
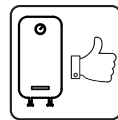
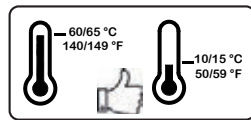
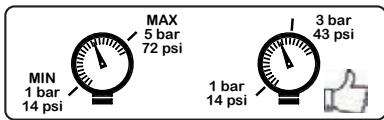

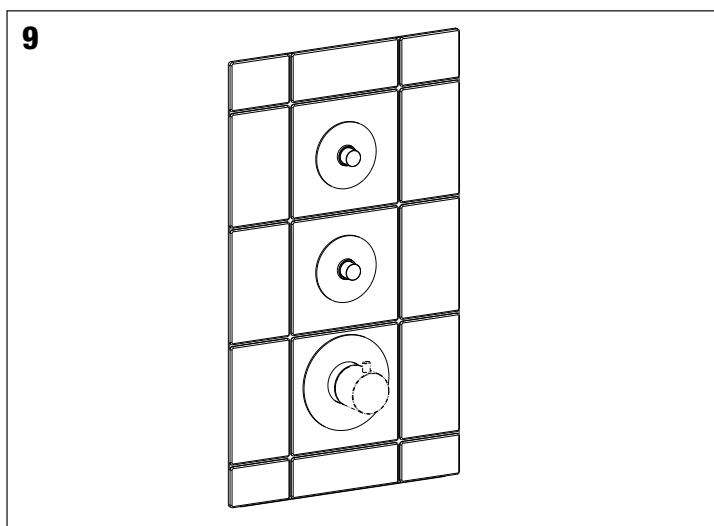
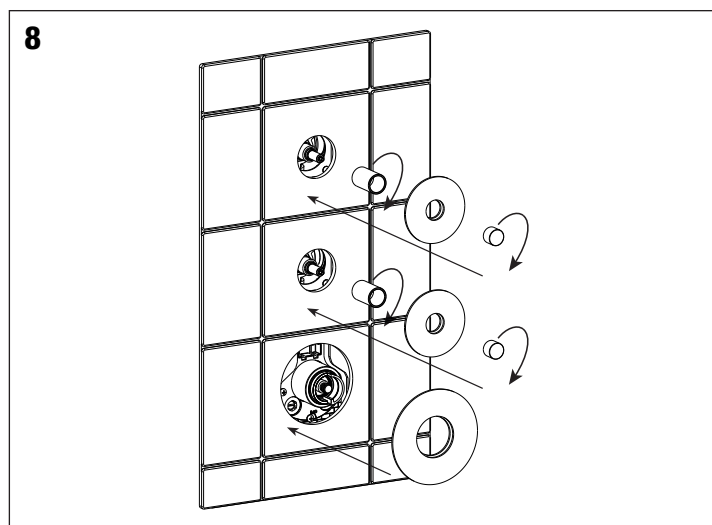
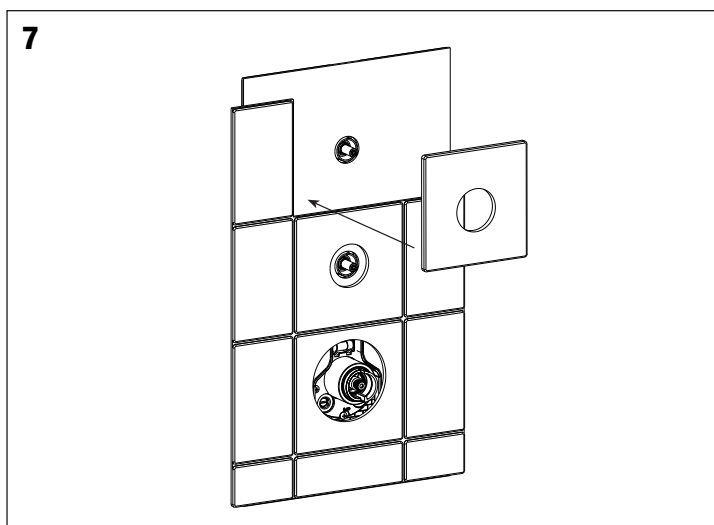

Sostituzione delle cartucce - Cartridges replacement

Prima di procedere alla manutenzione o alla sostituzione, chiudere l'acqua della rete idrica.
Turn off the mains water before carrying out maintenance or replacement operations.
Vor dem Austausch oder Wartungsarbeiten das Wasser am Haupthahn abstellen.

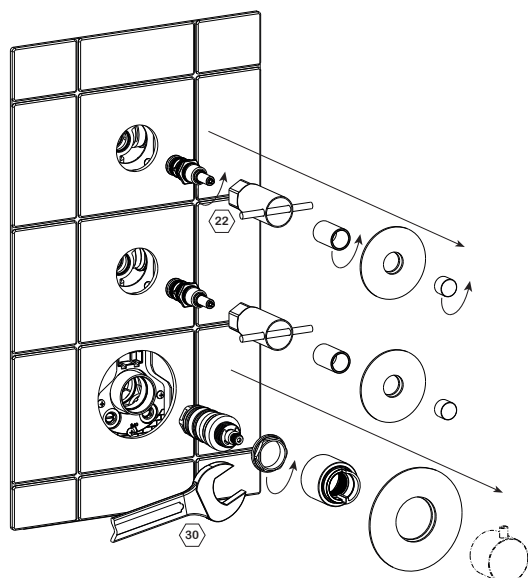

**Pulizia filtri / Sostituzione valvole non ritorno
Filters cleaning / Check valves replacement**

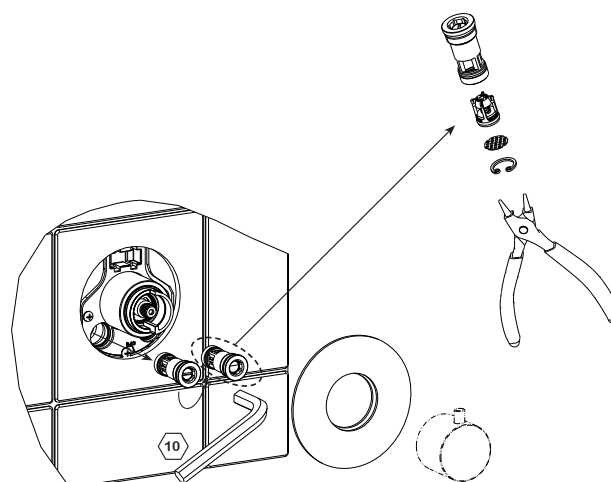

Miscelatore **termostatico doccia** incasso con presa acqua e supporto doccia *Concealed **thermostatic shower** mixer with water connection and shower bracket* Eingebaute **thermostatische** Mischbatterie für **Duschen** mit Wasseranschluss und Duschalterung



Diagramma di portata
(uscita libera)
*Flow diagram
(free exit)*
 Diagramm der
Durchflussleistung
(freier Ausgang)

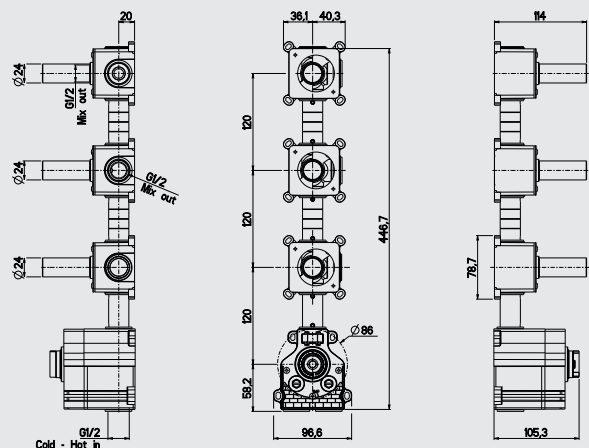
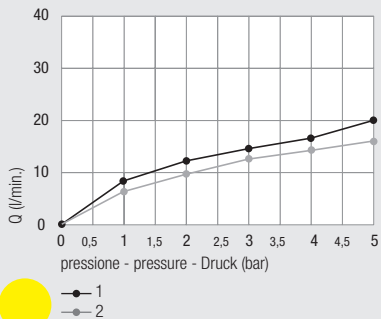

Design



Art.Q
 Versione quadrata
Square version
 Quadratische Ausführung

con deviatore **click-clack**
with click-clack diverter
 mit **click-clack**

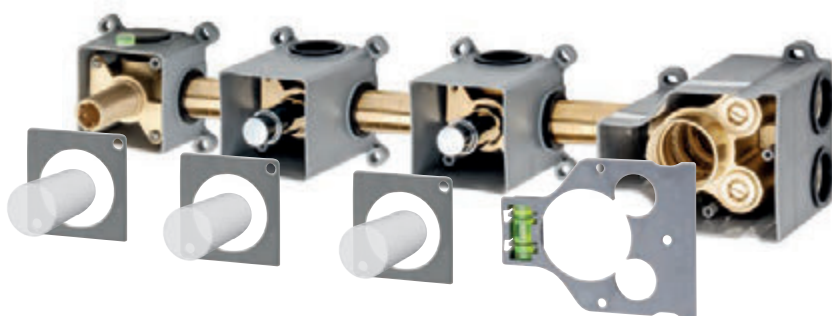

Art. GB2403-A21

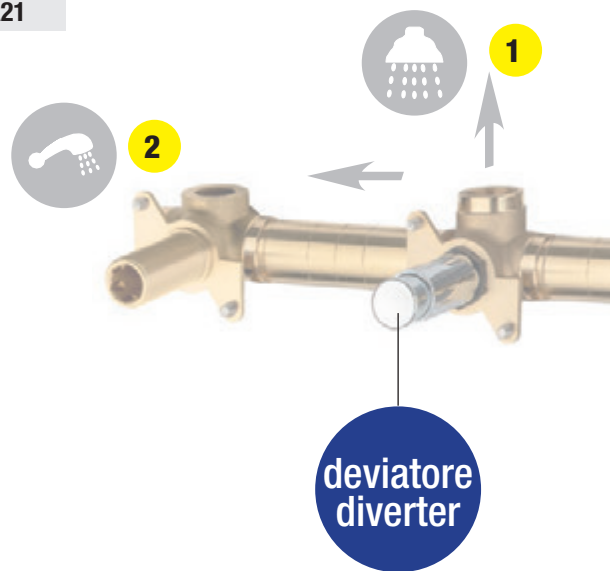

38°

2 exits

∅ 35

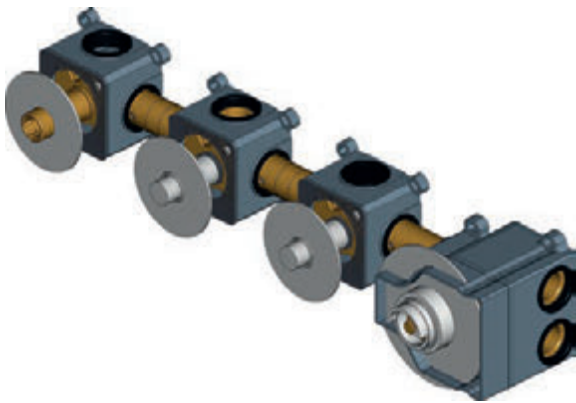

On/Off

per termostatico
for thermostatic
für thermostatische

Art. 8020

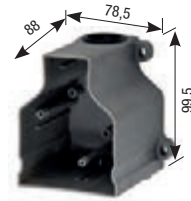

Art. 8021



Art. 8002

Anello per cartuccia termostatica
Ring for thermostatic cartridge
Ring für Thermostatkartusche

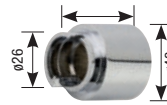

Art. 8009

Ghiera serraggio
Ring nut
Gewindeverschraubung



Art. MAN TH GB

Maniglia termostatico
Thermostatic handle
Thermostatgriff

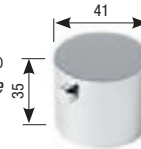

Art. TH ROS

Rosoni h 2 mm
Rosas h 2 mm
Rosas h 2 mm

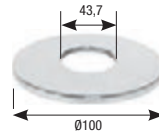

Art. 8001 KIT PRO

Prolunga termostatico
Thermostatic Extension
Thermostat-Erweiterung



Art. 3185

Prolunga G. 1/2"
Extension G. 1/2"
Verlängerung mit 1/2"-Drehung



Art. 3181G1/2

Guarnizione G. 1/2"
Gasket G. 1/2"
Dichtung mit 1/2"-Drehung



per deviatore
for diverter
für Umsteller

Art. 3195

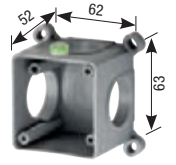

Art. 3196



Art. PR20K

Protezione in plastica
Plastic protection
Kunststoffschutzeinrichtung



Art. 1502ROS

Rosoni h 2 mm
Rosas h 2 mm
Rosas h 2 mm

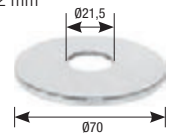

STAFF1

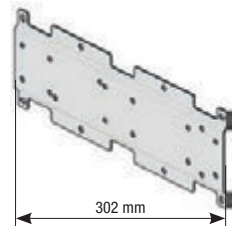

MIX THERMOSTATICI
INCASSO

7

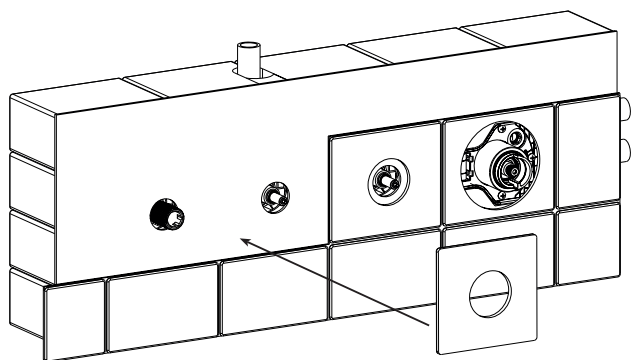

8

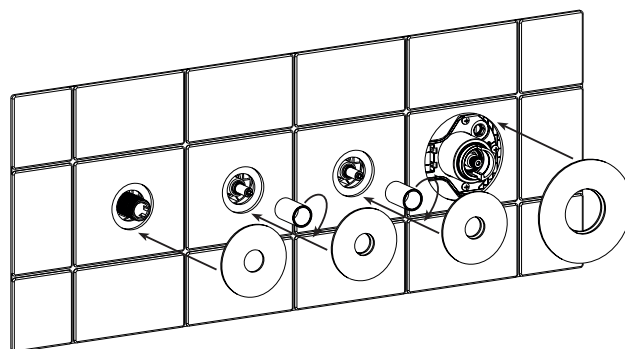

9

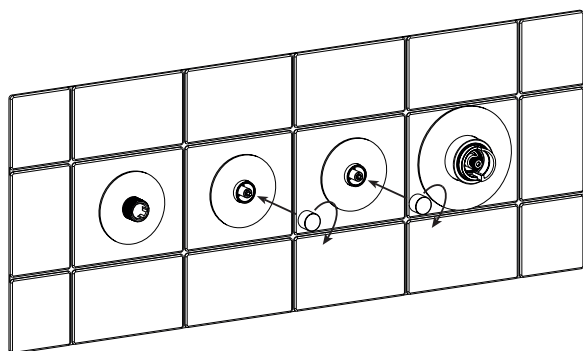

10

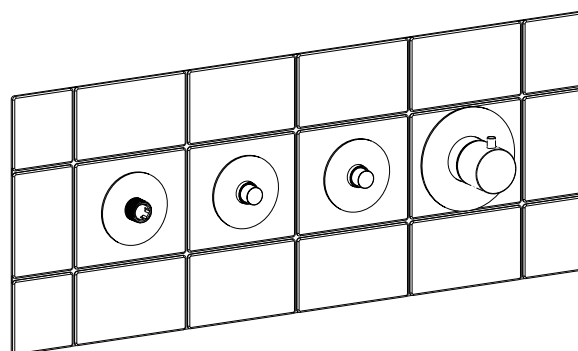

Sostituzione delle cartucce - Cartridges replacement

Prima di procedere alla manutenzione o alla sostituzione, chiudere l'acqua della rete idrica.
Turn off the mains water before carrying out maintenance or replacement operations.
Vor dem Austausch oder Wartungsarbeiten das Wasser am Haupthahn abstellen.

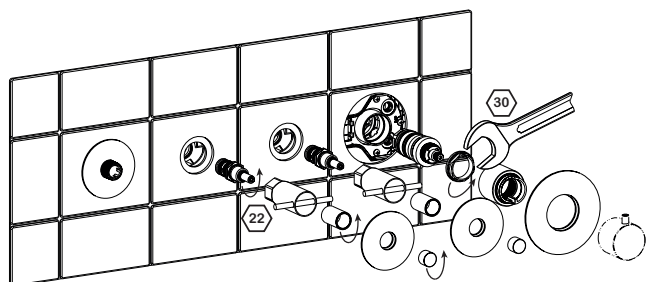

Pulizia filtri / Sostituzione valvole non ritorno Filters cleaning / Check valves replacement

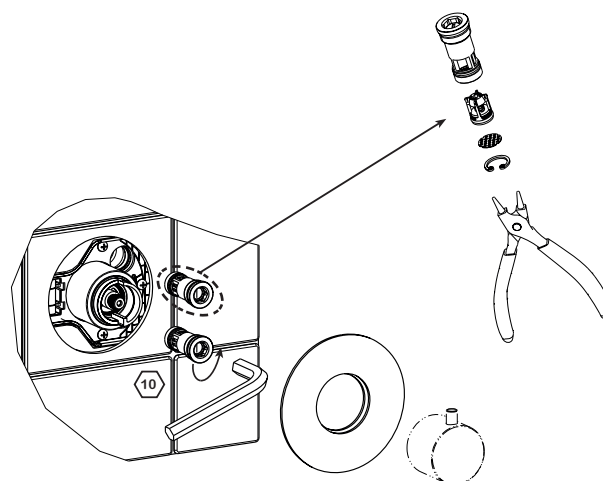

Miscelatore **termostatico doccia** incasso con collettore
*Concealed **thermostatic shower** mixer with manifold*
 Eingebaute **thermostatische** Mischbatterie für **Duschen** mit Kollektor

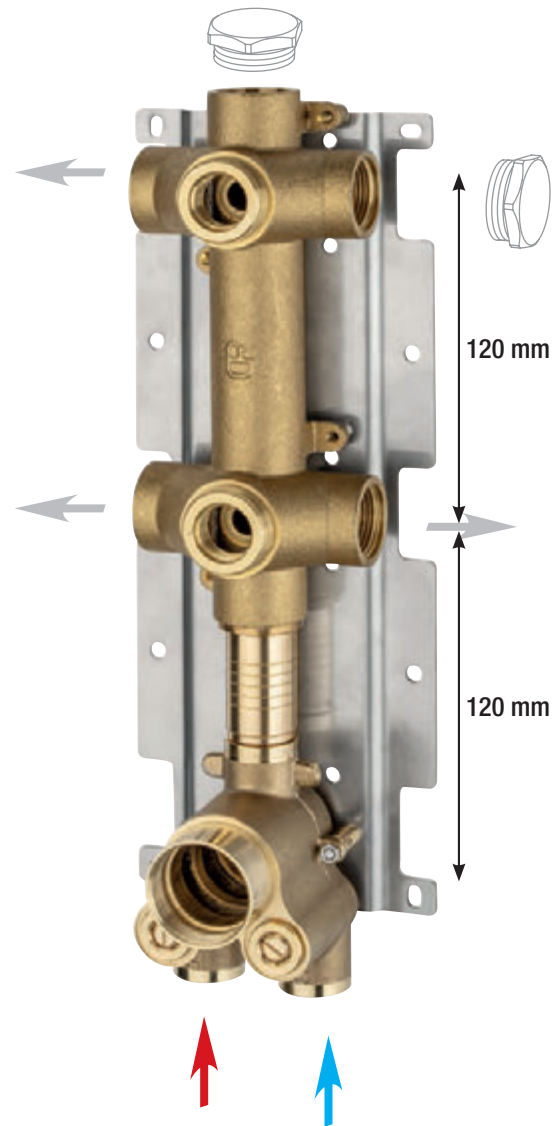
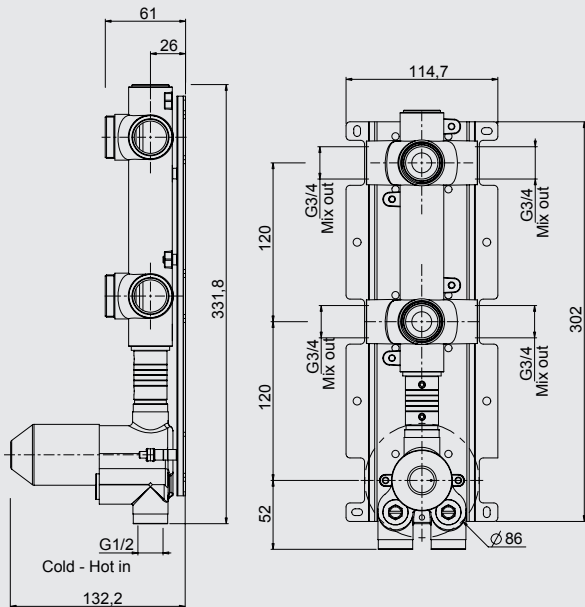

Art. 2403-M01

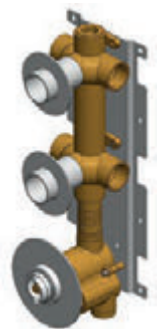

38°

4/6 exits

Ø 35

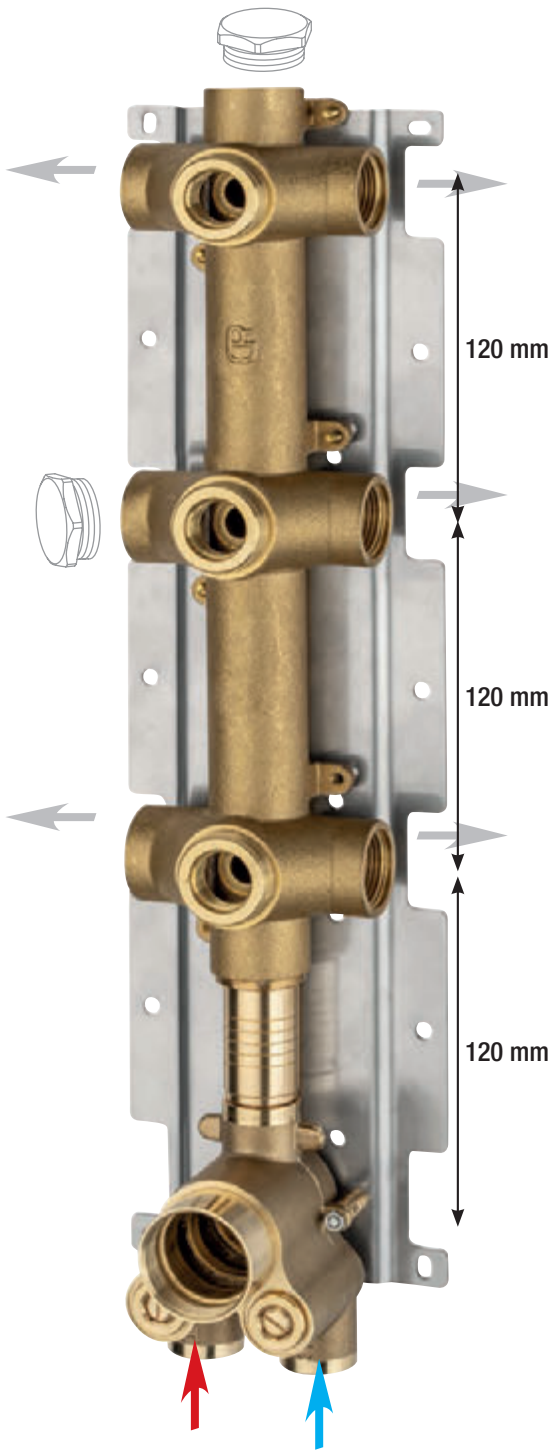

Art. 2403-N01

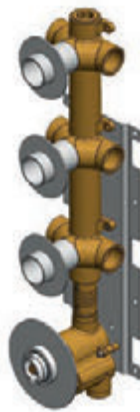

per termostatico
for thermostatic
für thermostatische

Art. 8002
Anello per cartuccia termostatica
Ring for thermostatic cartridge
Ring für Thermostatkartusche

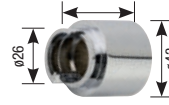

Art. 8009
Ghiera serraggio
Ring nut
Gewindeverschraubung



Art. MAN TH GB
Maniglia termostatico
Thermostatic handle
Thermostatgriff

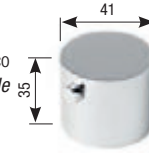

Art. TH ROS
Rosoni h 2 mm
Rosas h 2 mm
Rosas h 2 mm

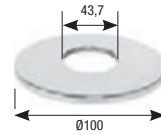

Art. 8001 KIT PRO
Prolunga termostatico
Thermostatic Extension
Thermostat-Erweiterung



per collettore
for manifold
für Kollektor

Art. 00140
Coprivitone
Headwork cover ring
Oberteilabdeckung



Art. 327ROS
Rosoni h 3 mm
Rosas h 3 mm
Rosas h 3 mm

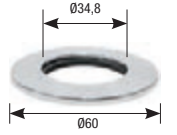

Art. STAFF 2

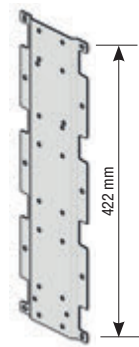

Art. STAFF 1

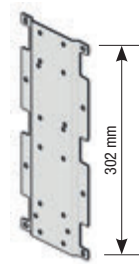

Miscelatore **termostatico doccia** incasso
Concealed **thermostatic shower mixer**
 Eingebaute **thermostatische** Mischbatterie für **Duschen**

38°

2/3 exits

Ø 35

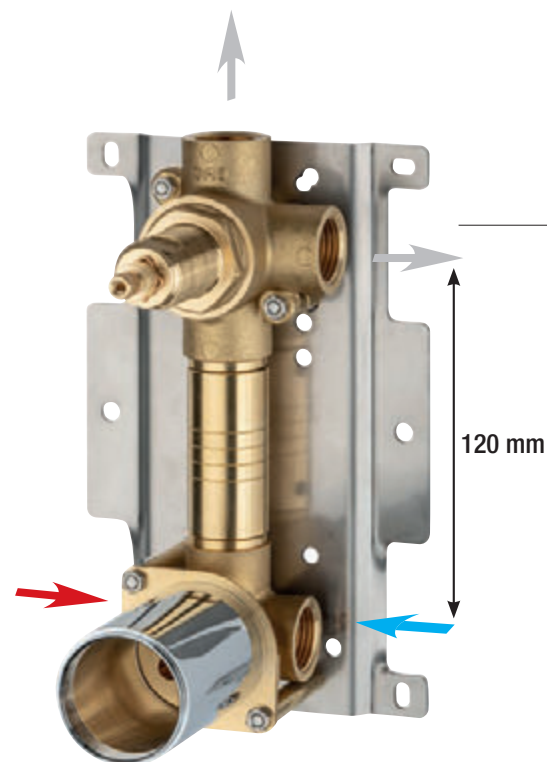
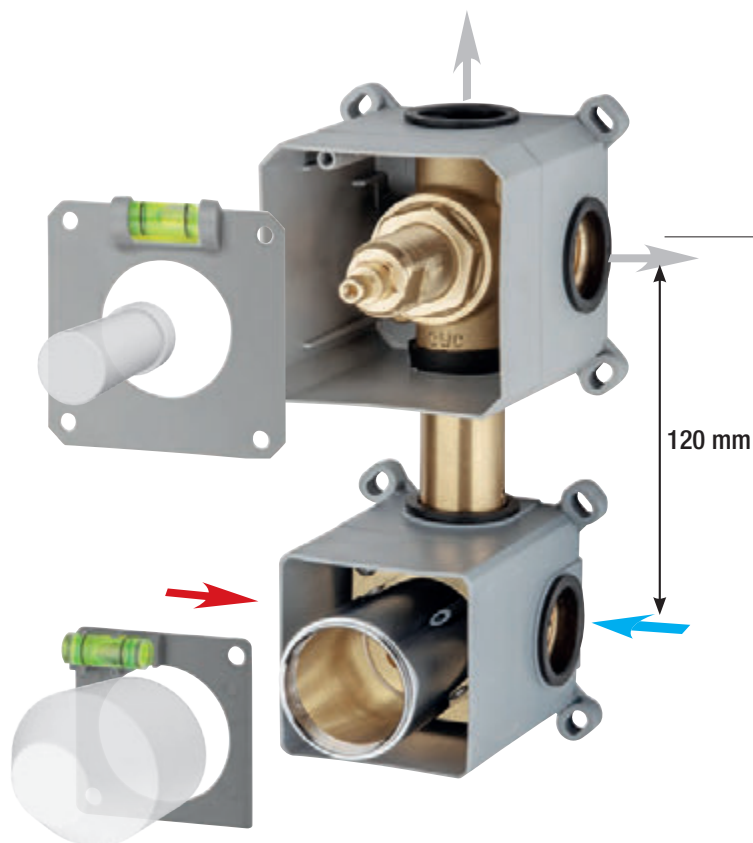
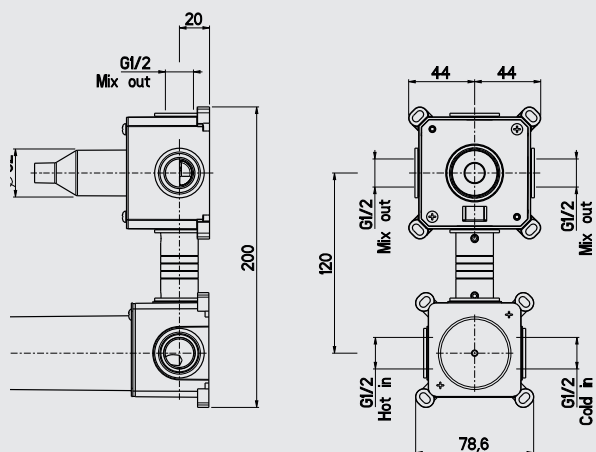

con deviatore **ceramico**
with **ceramic diverter**
Keramik-Umstellventil



Art. 2003GRFA



Art. 2000FS



Art. 2001FS



INSTALLATION next page

con **scatola** - with **box** - mit **Unterputzdose**

Art. 2403G01



Art. 2403H01



Art. 2403F01



con **piastra** - with **plate** - mit **Platte**

Art. 2403Q01

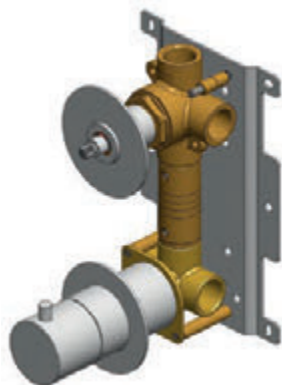

Art. 2403R01

Art. 2403P01

per termostatico
for *thermostatic*
für *thermostatische*

Art. 3195

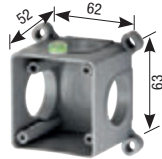

Art. 3196



Art. CARTTH35

Cartuccia termostatica
Thermostatic cartridge
Thermostatkartusche



Art. FERMOTH35

Fermo Cartuccia termostatica
Thermostatic cartridge stop
Thermostatkartuschen-Absperrung



Art. 1004TH

Ghiera
Ring nut
Gewindehülse



Art. 1013/35 L63

Anello sede cartuccia
Cartridge ring seat
Kartuschenringsitz



Art. PRTHAR

Protezione termostatico
Thermostatic protection
Schutzvorrichtung
thermostatische



Art. MAN TH GB

Maniglia termostatico
Thermostatic handle
Thermostatgriff

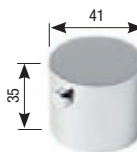

Art. 8001 KIT PRO

Prolunga termostatico
Thermostatic Extension
Thermostat-Erweiterung



Art. 1013/35ROS

Rosoni h 2 mm
Rosas h 2 mm
Rosas h 2 mm

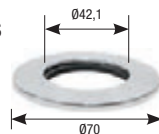

Art. 3185

Prolunga G.1/2"
Extension G.1/2"
Verlängerung mit 1/2"-Drehung



Art. 3181G1/2

Guarnizione G.1/2"
Gasket G.1/2"
Dichtung mit 1/2"-Drehung



per deviatore
for *diverter*
für *Umsteller*

Art. 3190

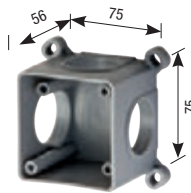

Art. 3189



Art. PR22/19

Protezione coprifiletto
Thread protection
Gewindeabdeckungsschutz



Art. 00120

Maniglia deviatore
Diverter handle
Umstellgriff

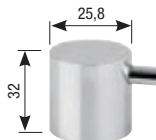

Art. 00080

Coprifiletto deviatore cromato
Diverter cover thread
Verchromte
Gewindeabdeckung
Umstellventil

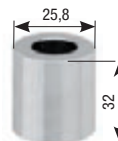

Art. 00080ROS

Rosoni h 2 mm
Rosas h 2 mm
Rosas h 2 mm

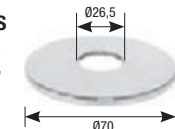

Art. 640

Prolunga deviatore
Diverter extension
Verlängerung
Umstellventil

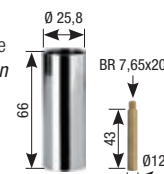

Art. 640A

Prolunga deviatore
Diverter extension
Verlängerung
Umstellventil

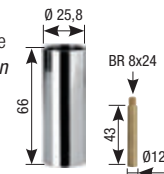

Art. STAFF

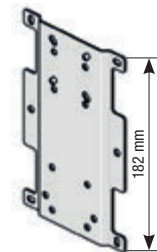

MIX THERMOSTATICI
INCASSO

Installazione e manutenzione
Installation and maintenance
Installation und wartung

Art. 2403-G01/H01/F01

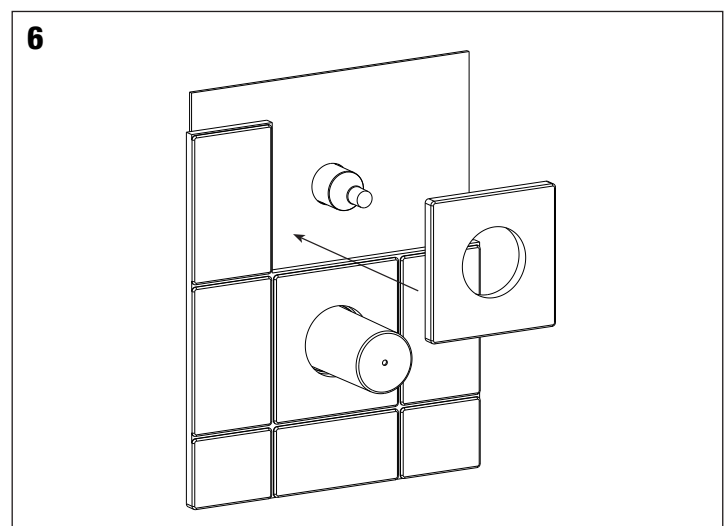
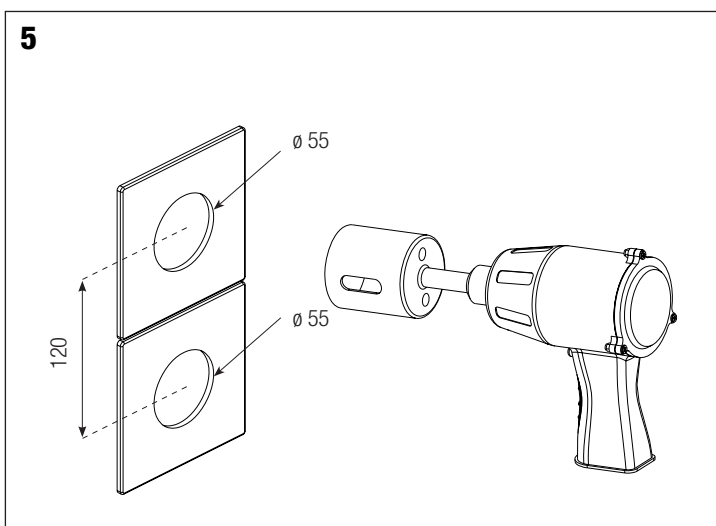
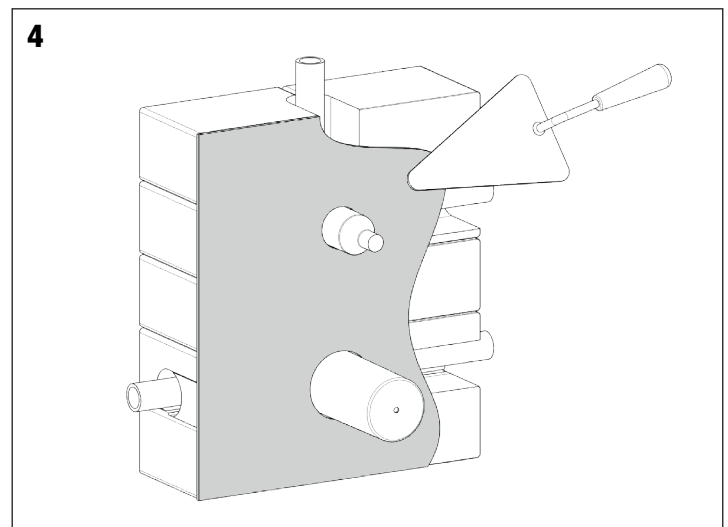
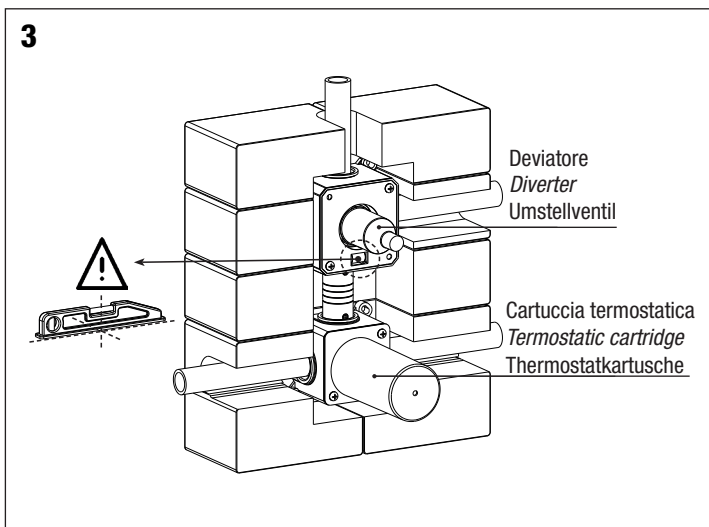
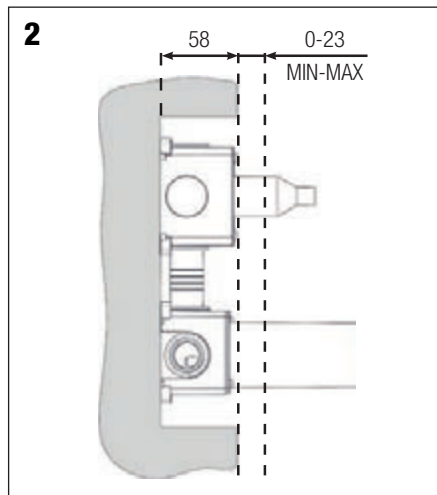
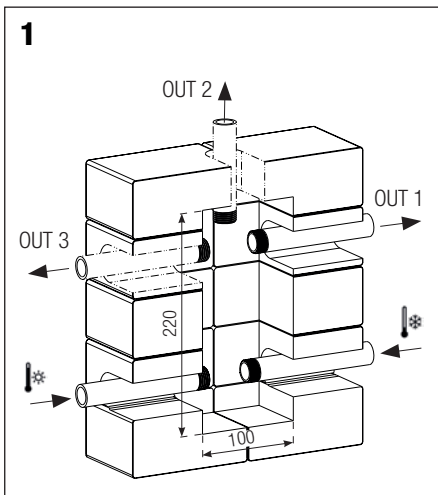
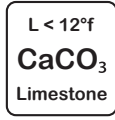
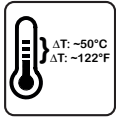
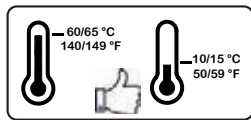
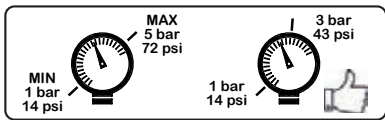

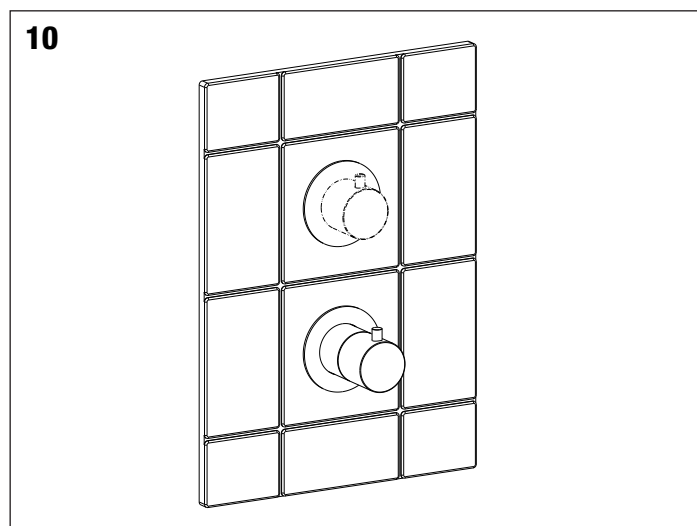
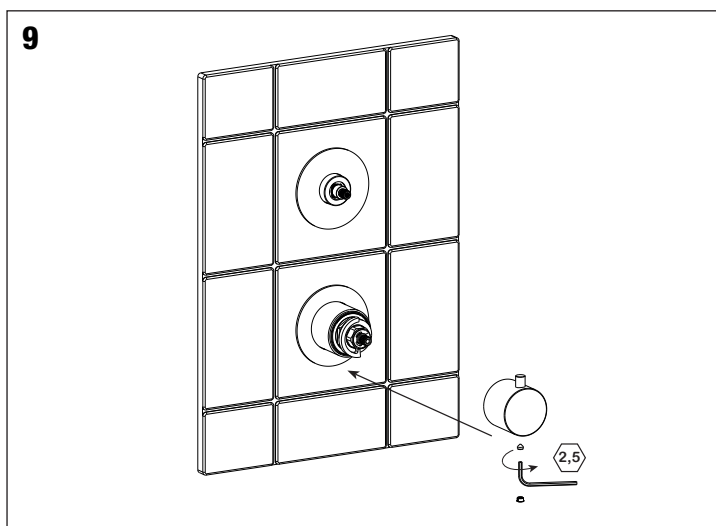
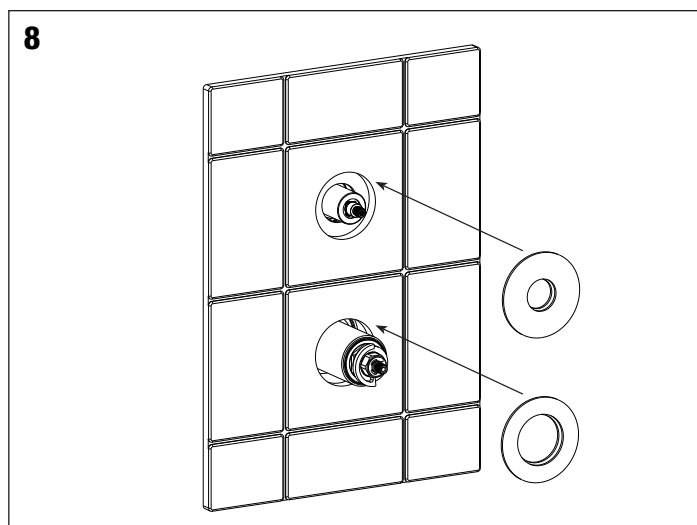
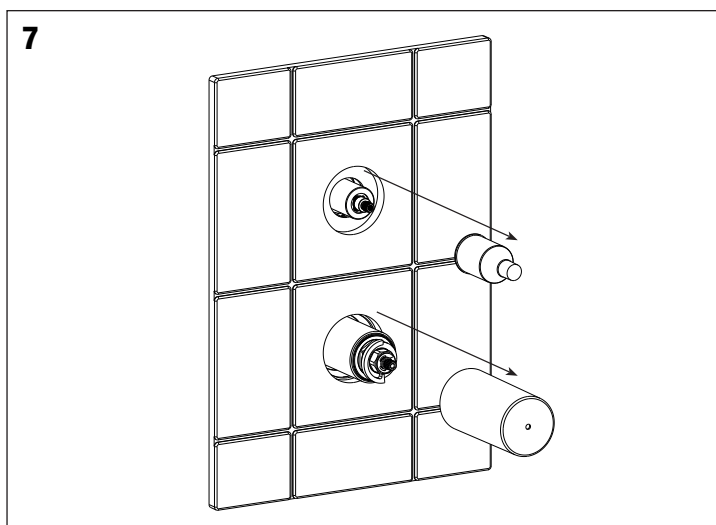

Sostituzione delle cartucce - Cartridges replacement

Prima di procedere alla manutenzione o alla sostituzione, chiudere l'acqua della rete idrica.
 Turn off the mains water before carrying out maintenance or replacement operations.
 Vor dem Austausch oder Wartungsarbeiten das Wasser am Haupthahn abstellen.

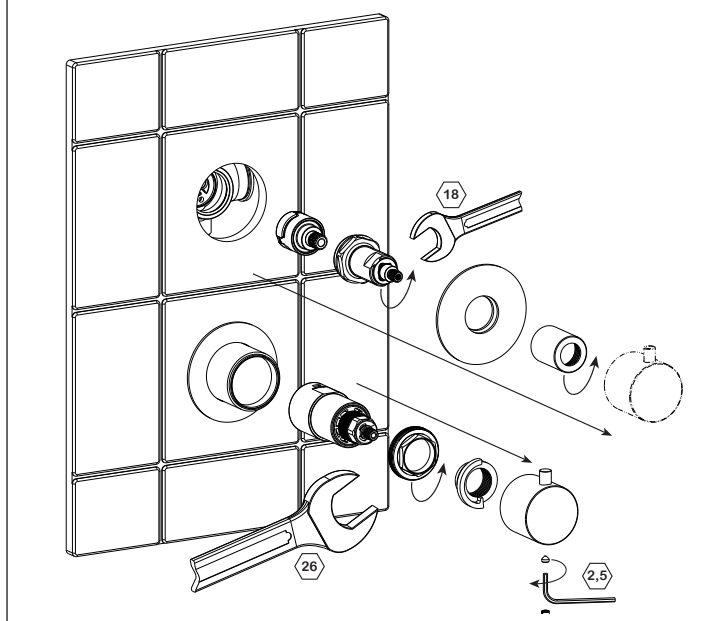

Miscelatore termostatico doccia incasso

Concealed *thermostatic shower mixer*

Eingebaute *thermostatische* Mischbatterie für **Duschen**

con deviatore **click-clack**
with click-clack diverter
 mit **click-clack**



DZR
Available

Diagramma di portata
(uscita libera)
*Flow diagram
(free exit)*
 Diagramm der
Durchflussleistung
(freier Ausgang)

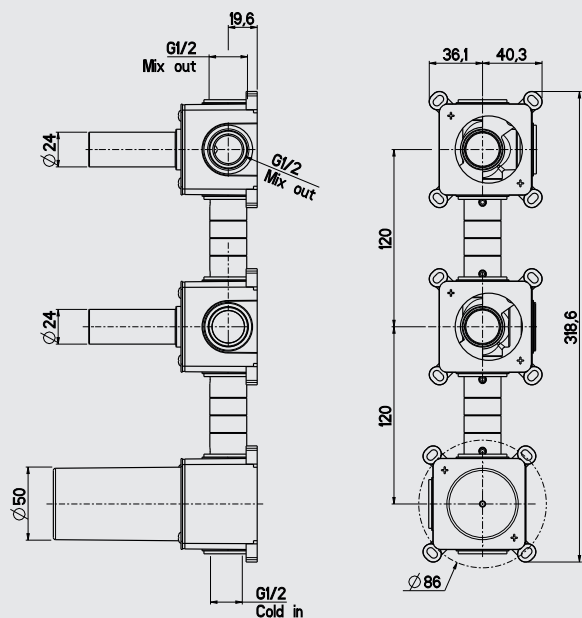
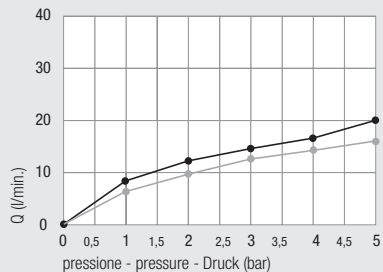

Design



Art.Q
 Versione quadrata
Square version
 Quadratische Ausführung

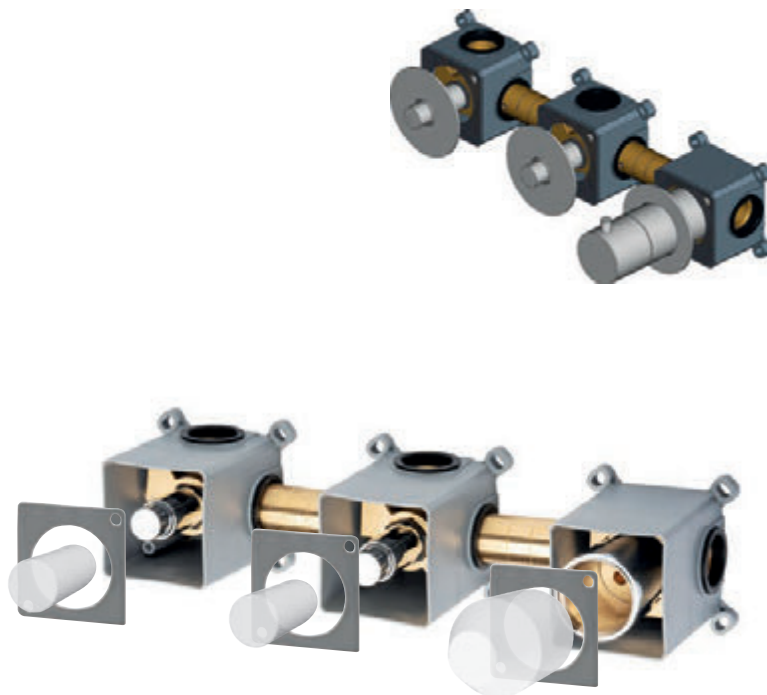

INSTALLATION next page

con **scatola** - *with box* - mit **Unterputzdose**

Art. GB2403-E01

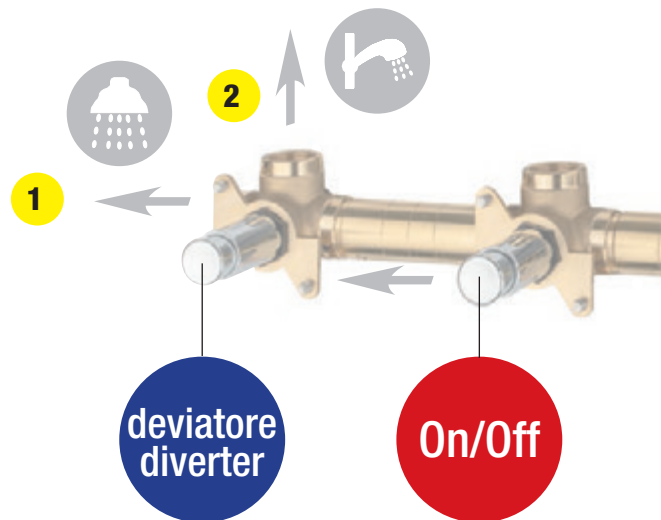

38°

4/6 exits

Ø35

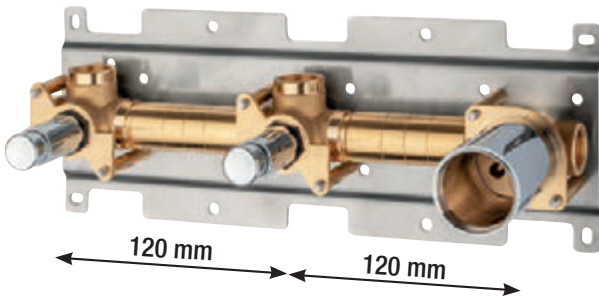
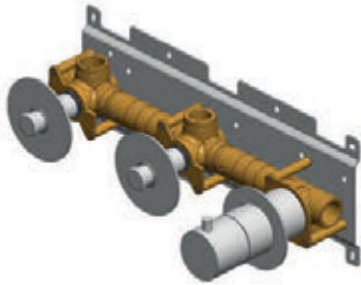

con piastra - with plate - mit Platte

Art. GB2403-001



per termostatico e per deviatore

for thermostatic and for diverter
für Thermostat und Umsteller

Art. 3195

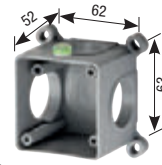

Art. 3196



per termostatico

for thermostatic
für thermostatische

Art. CARTTH35

Cartuccia termostatica
Thermostatic cartridge
Thermostatkartusche



per deviatore

for diverter
für Umsteller

Art. PR20K

Protezione in plastica
Plastic protection
Kunststoffschutzvorrichtung



Art. FERMOTH35

Fermo Cartuccia termostatica
Thermostatic cartridge stop
Thermostatkartuschen-Abspernung



Art. 1502ROS

Rosoni h 2 mm
Rosas h 2 mm
Rosas h 2 mm

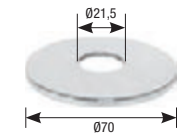

Art. 1004TH

Ghiera
Ring nut
Gewindehülse

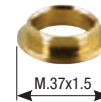

Art. 1013/35ROS

Rosoni h 2 mm
Rosas h 2 mm
Rosas h 2 mm

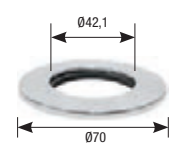

Art. 1013/35 L63

Anello sede cartuccia
Cartridge ring seat
Kartuschenringsitz



Art. PRTHAR

Protezione termostatico
Thermostatic protection
Schutzvorrichtung
thermostatische



Art. MAN TH GB

Maniglia termostatico
Thermostatic handle
Thermostatgriff

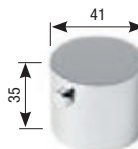

Art. 8001 KIT PRO

Prolunga termostatico
Thermostatic Extension
Thermostat-Erweiterung



Art. 3185

Prolunga G. 1/2"
Extension G. 1/2"
Verlängerung mit 1/2"-Drehung



STAFF1

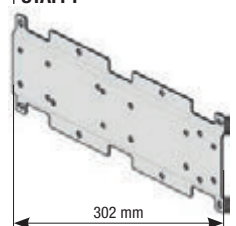

Art. 3181G1/2

Guarnizione G. 1/2"
Gasket G. 1/2"
Dichtung mit 1/2"-Drehung



Installazione e manutenzione
Installation and maintenance
Installation und wartung

Art. 2403-E01

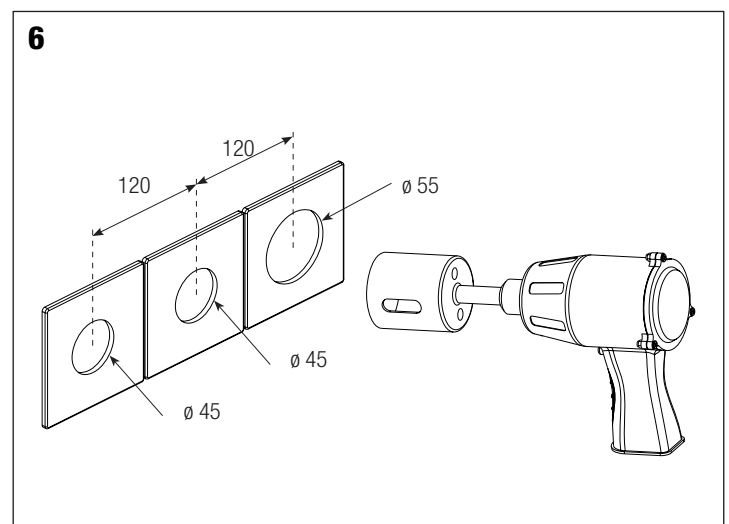
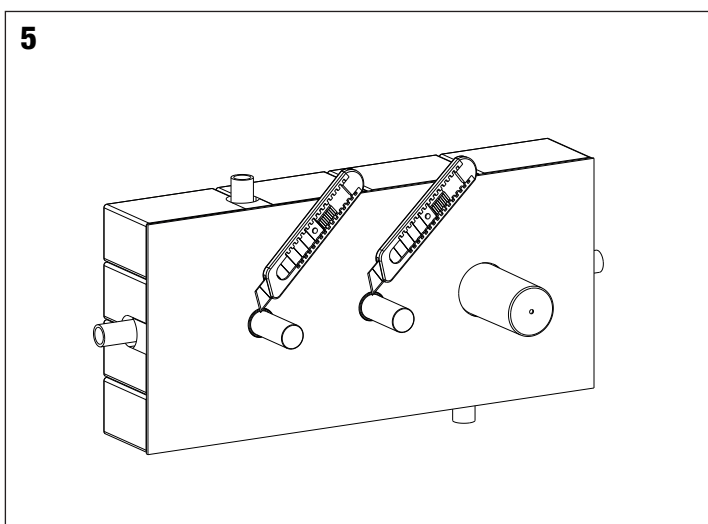
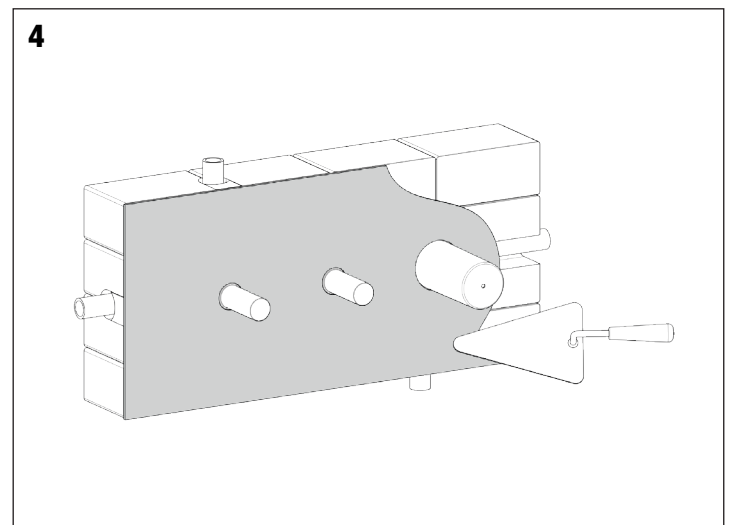
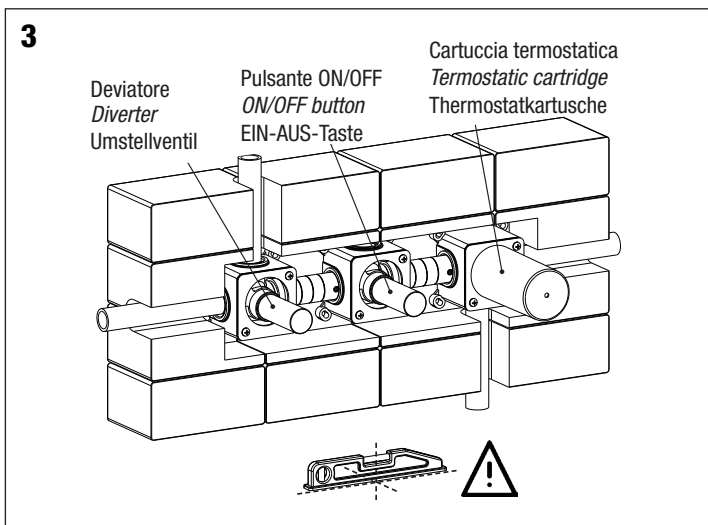
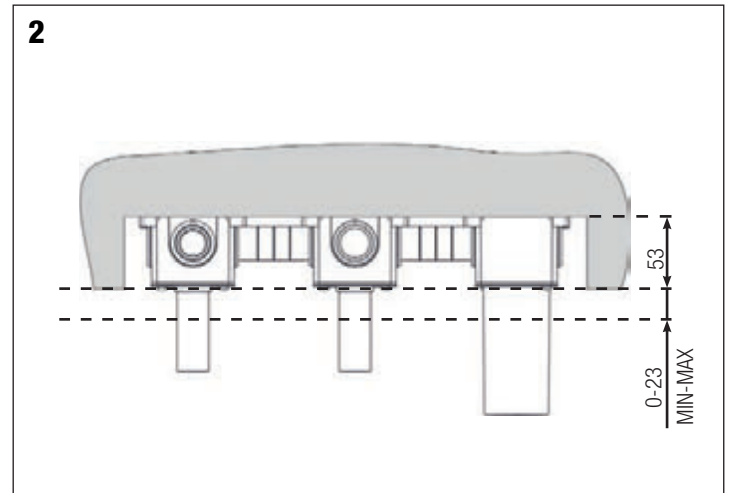
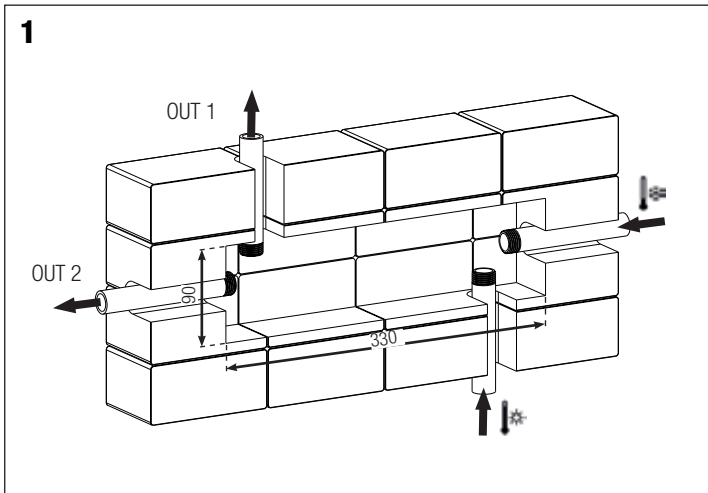
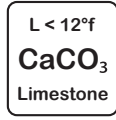
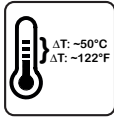
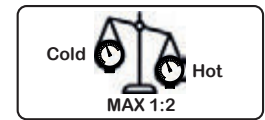
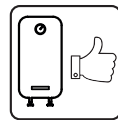
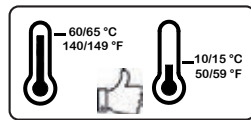
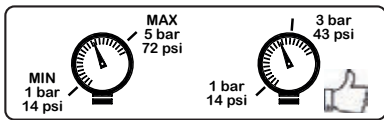

7

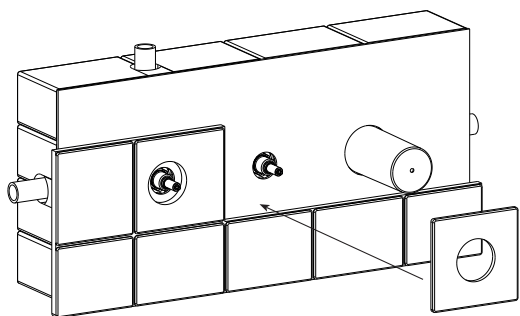

8

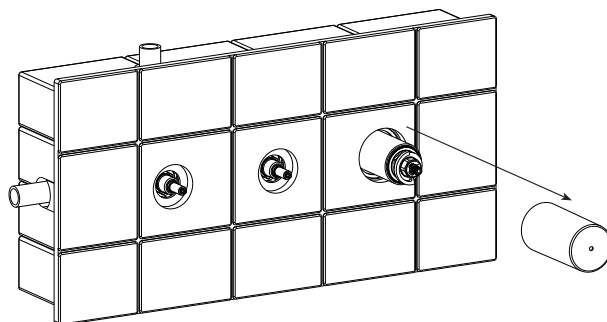

9

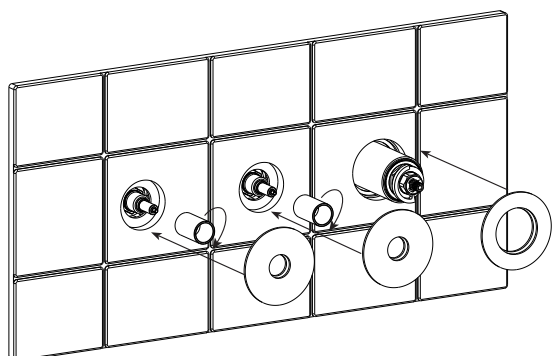

10

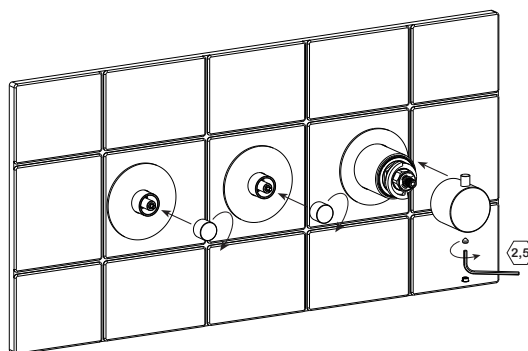

11

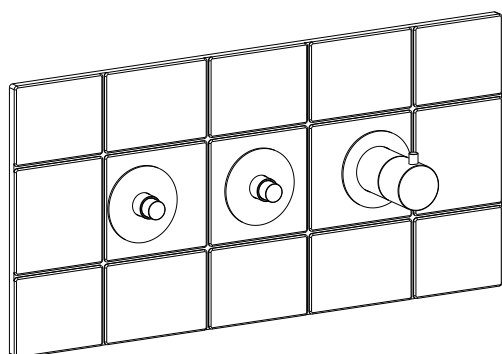

Sostituzione delle cartucce - Cartridges replacement

Prima di procedere alla manutenzione o alla sostituzione, chiudere l'acqua della rete idrica.
Turn off the mains water before carrying out maintenance or replacement operations.
Vor dem Austausch oder Wartungsarbeiten das Wasser am Haupthahn abstellen.

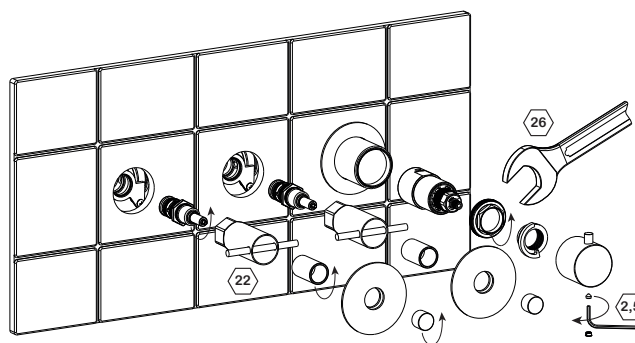

Miscelatore **termostatico doccia** incasso **coassiale** con deviatore
Concealed coaxial thermostatic shower mixer with diverter
 Koaxialer Eingebaute **thermostatische** Mischbatterie für **Duschen** mit Umsteller

Ø40 2 exits

DZR
Available

Diagramma di portata (uscita libera)
Flow diagram (free exit)
 Diagramm der Durchflussleistung (freier Ausgang)

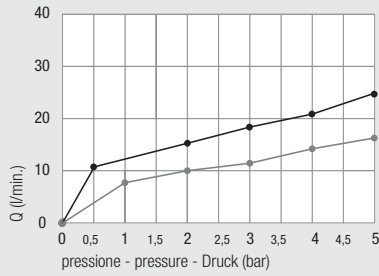

● vasca *bath exit* Badewanne
 ● doccia *shower* Dusche

Art. 2180TH

cartuccia con chiusura
cartridge with OFF function
 Kartusche mit OFF

38°

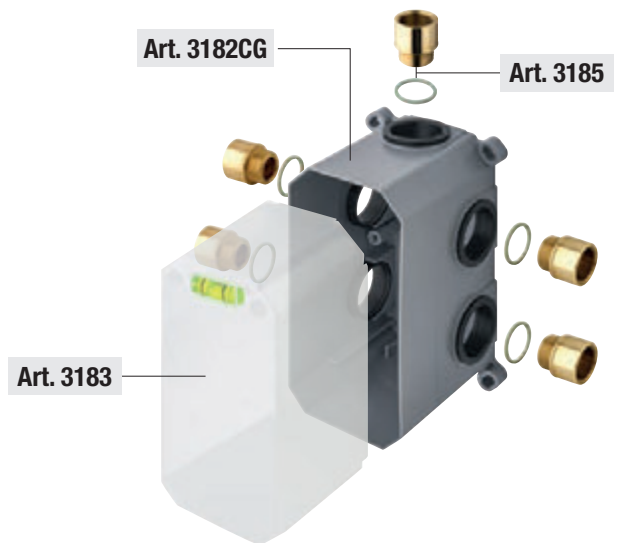
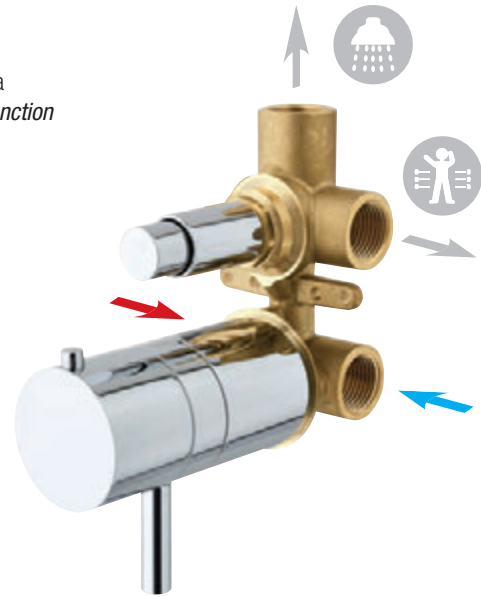

INSTALLATION Art. 3182CG page 164

Art. 610
 Prolunga deviatore
Diverter extension
 Verlängerung Umstellventil

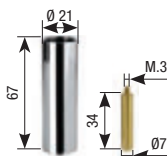

Art. 3182CG
 Scatola di assemblaggio System box
Multipurpose assembling box System box
 Montagegehäuse System box

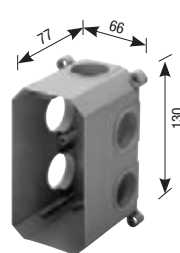

Art. 3181ME
 Membrana isolante
Insulating membrane
 Isolierungsmembran
 330x230 mm

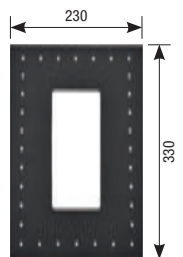

Art. PR20
 Protezione in plastica
Plastic protection
 Kunststoffschutzvorrichtung



Art. 3183
 Coperchio scatola
Box cover
 Gehäuseabdeckung



Art. 3185
 Prolunga G. 1/2"
extension G. 1/2"
 Verlängerung mit 1/2"-Drehung



Art. 3181G1/2
 Guarnizione G. 1/2"
Gasket G. 1/2"
 Dichtung mit 1/2"-Drehung



