

Deviatori ceramici

Ceramic diverters

Keramik-Umstellventile

Deviatori a 2/3/4/5 vie
dischi ceramici sinterizzati

*2/3/4/5 ways diverter
syntherized ceramic disks*

2-/3-/4/5-Wege Umstellventile
gesinterte Keramikscheiben

Due possibilità di utilizzo

Funzione d'arresto OFF: nell'uso dei termostatici vengono eliminati i rubinetti d'arresto con la possibilità di sfruttare più vie.

Economizzatore: la posizione centrale della leva permette una grande economia d'acqua senza utilizzare continuamente i rubinetti laterali. Entrambi le funzioni sono regolabili sia in utilizzo vasca che in utilizzo doccia, eliminando gli sprechi d'acqua.

Two possible applications

Stop function/Off: when using thermostatics, stopcocks are eliminated and more ways can be used.

Save: the central position of the lever allows a considerable water saving and the normal flow rate can be restored simply selecting shower or bath exit.

Zwei Anwendungsmöglichkeiten

Stopp-Funktion OFF: Beim Einsatz von Thermostaten kann man auf Abstellhähne verzichten und somit das Mehrwegesystem nutzen.

Ekonomiser: Die zentrale Einstellung des Hebels ermöglicht eine große Wassereinsparung ohne kontinuierlich die seitlichen Armaturen zu benutzen. Beide Funktionen sind sowohl bei der Nutzung für die Badewanne, als auch für die Dusche einstellbar, so dass eine Wasserverschwendung vermieden wird.

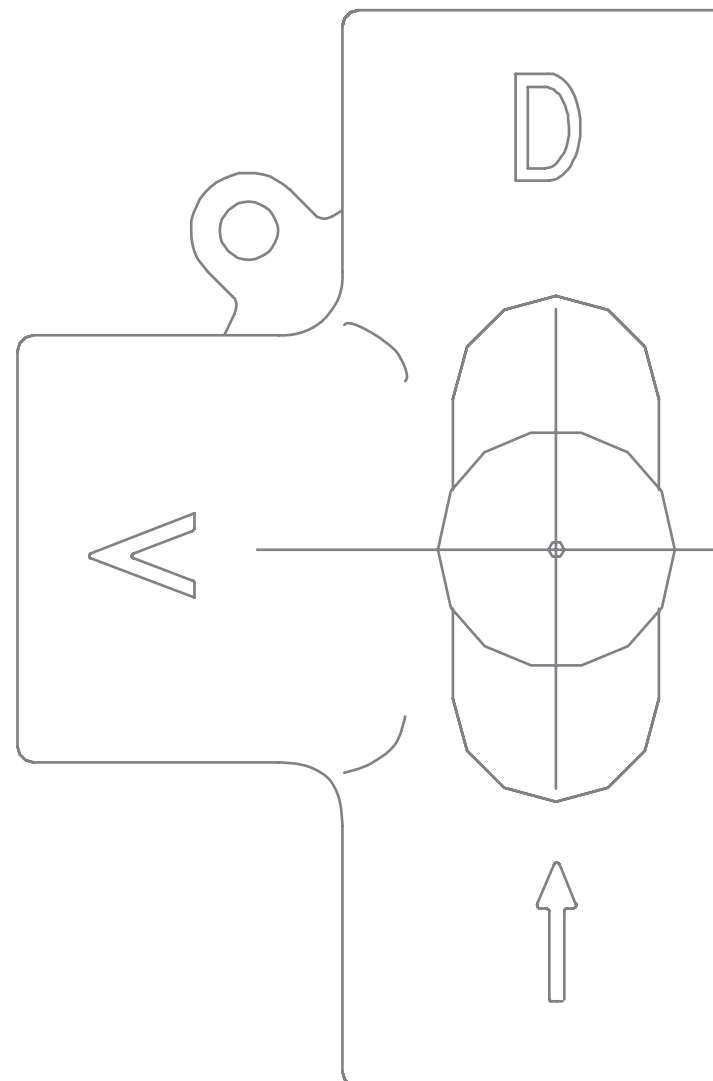

Deviatore ceramico

Ceramic diverter

Keramik-Umstellventil

2 exits

2 entrate, 2 uscite
2 entries, 2 exits
2 Eingänge, 2 Ausgänge

DZR
Available

Diagramma di portata
(uscita libera)

Flow diagram
(free exit)

Diagramm der
Durchflussleistung
(freier Ausgang)

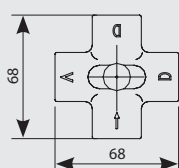
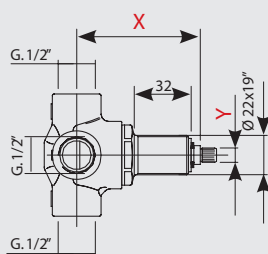
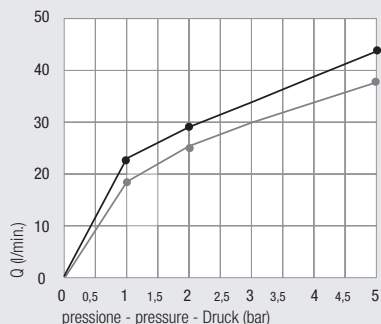

X	Y
72	BR. Ø 7,65 x Z=20 BR. Ø 8 x Z=24
83,5	BR. Ø 7,65 x Z=20 BR. Ø 8 x Z=24
92	BR. Ø 7,65 x Z=20 BR. Ø 8 x Z=24
112,5	BR. Ø 7,65 x Z=20 BR. Ø 8 x Z=24

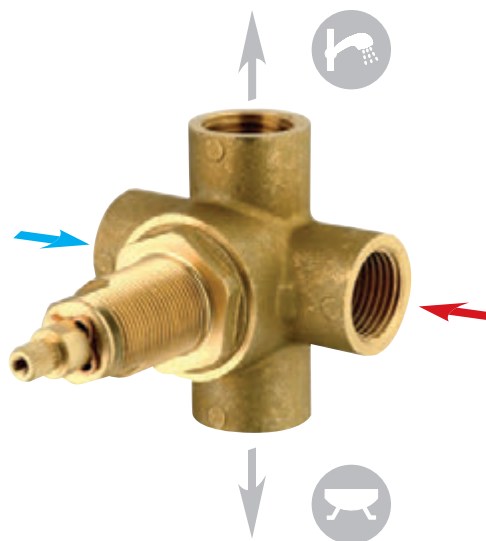

Art. 1110

CON economizzatore
WITH saving function
MIT Economiser

ECO

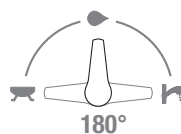

Art. 1110/90

SOLO deviatore
diverter ONLY
NUR Umstellventil



Gebis
water control

INSTALLATION Art. 3188 page 150 - Art. 3190 page 152

Art. 00120
Maniglia deviatore
Diverter handle
Umstellgriffn

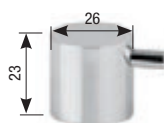

Art. 3188
Scatola di assemblaggio
Multipurpose assembling box
Montagegehäuse

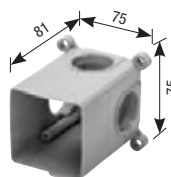

Art. 3189
Plastra copriscatola
Box cover plate
Abdeckplatte des Kastens



Art. 00080
Coprifiletto deviatore cromato
Diverter cover thread
Verchromte Gewindeabdeckung
für das Umstellgriffn

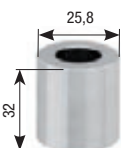

Art. 3190
Scatola di assemblaggio
Multipurpose assembling box
Montagegehäuse

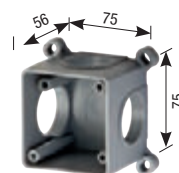

Art. 3188ME
Membrana isolante
Insulating membrane
Isolierungsmembran

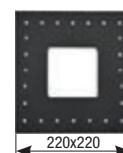

Deviatore ceramico

Ceramic diverter

Keramik-Umstellventil

3
exits

1 entrata, 3 uscite
1 entry, 3 exits
1 Eingang, 3 Ausgänge



Diagramma di portata
(uscita libera)

Flow diagram
(free exit)

Diagramm der
Durchflussleistung
(freier Ausgang)

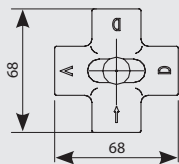
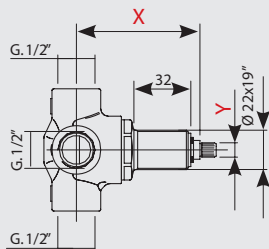
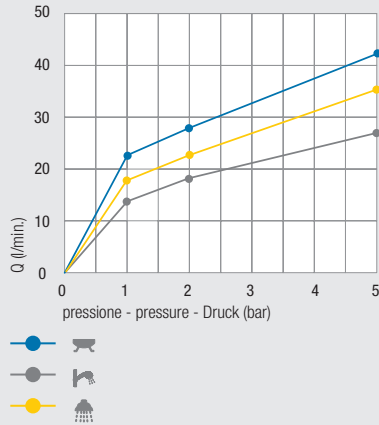

X	Y
72	BR. Ø 7,65 x Z=20 BR. Ø 8 x Z=24
83,5	BR. Ø 7,65 x Z=20 BR. Ø 8 x Z=24
92	BR. Ø 7,65 x Z=20 BR. Ø 8 x Z=24
112,5	BR. Ø 7,65 x Z=20 BR. Ø 8 x Z=24

Gebis
water control

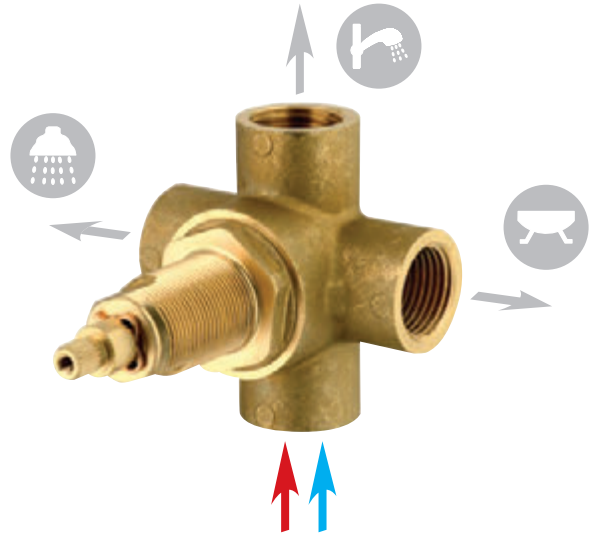

Art. 2203

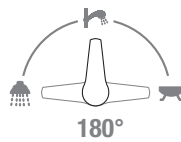

Art. 2203CA

CON alette di fissaggio
WITH fixing system
MIT Befestigungsrippen

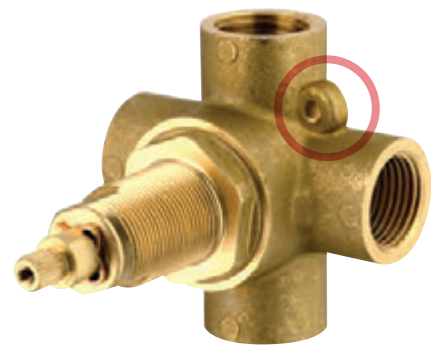

INSTALLATION Art. 3188 page 150 - Art. 3190 page 152

Adattatore
Ring adaptor
Adapter

Art. 2501 A Ø 26X19"
Art. 2502 A Ø 27X19"
Art. 2504 A G.3/4"



Art. 00080ROS
Rosoni h 2 mm
Rosas h 2mm
Rosas h 2 mm

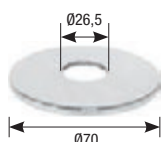

Art. 3181G1/2
Guarnizione G.1/2"
Gasket G.1/2"
Dichtung mit 1/2"-Drehung



Art. PR22/19
Protezione coprifiletto
Thread protection
Gewindeabdeckungsschutz

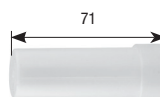

Deviatore ceramico

Ceramic diverter

Keramik-Umstellventil



Diagramma di portata
(uscita libera)

Flow diagram
(free exit)

Diagramm der
Durchflussleistung
(freier Ausgang)

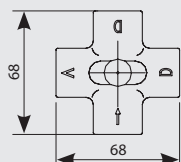
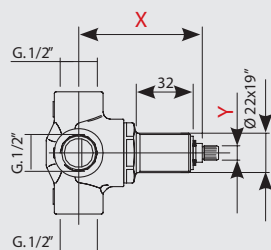
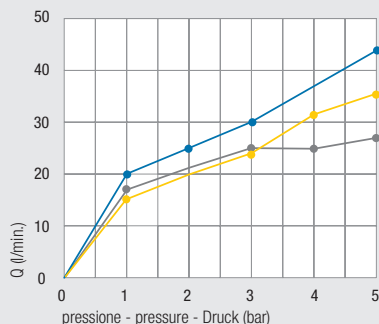

X	Y
72	BR. Ø 7,65 x Z=20 BR. Ø 8 x Z=24
83,5	BR. Ø 7,65 x Z=20 BR. Ø 8 x Z=24
92	BR. Ø 7,65 x Z=20 BR. Ø 8 x Z=24
112,5	BR. Ø 7,65 x Z=20 BR. Ø 8 x Z=24

Gebis
water control

3 exits

1 entrata, 3 uscite, con OFF
1 entry, 3 exits and OFF position
1 Eingang, 3 Ausgänge mit OFF

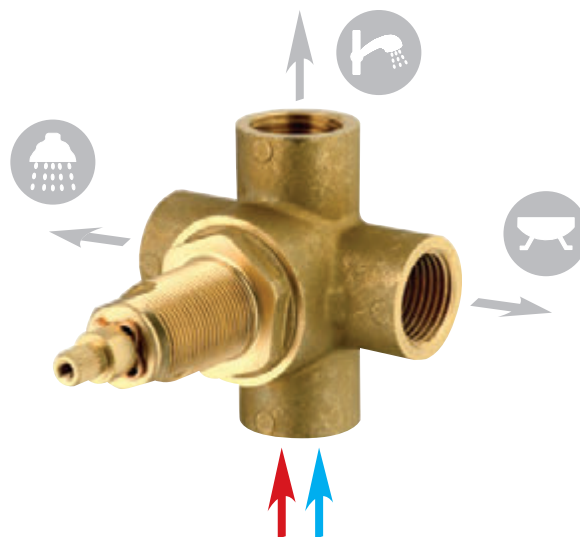

NPT
Available

Art. 2202

Art. 2202 S/F



Art. 2202CA

Art. 2202CA S/F

CON alette di fissaggio
WITH fixing sytem
MIT Befestigungsrippen

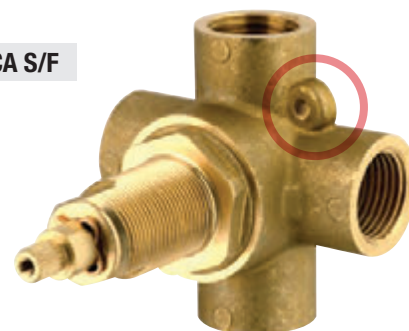

INSTALLATION Art. 3188 page 150 - Art. 3190 page 152

Art. 00120
Maniglia deviatore
Diverter handle
Umstellgriffn

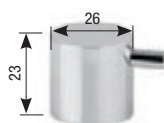

Art. 3188
Scatola di assemblaggio
Multipurpose assembling box
Montagegehäuse

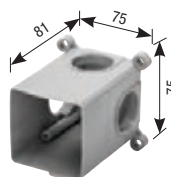

Art. 3189
Piastra copriscatola
Box cover plate
Abdeckplatte des Kastens



Art. 00080
Coprifiletto deviatore cromato
Diverter cover thread
Verchromte Gewindeabdeckung
für das Umstellventil

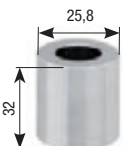

Art. 3190
Scatola di assemblaggio
Multipurpose assembling box
Montagegehäuse

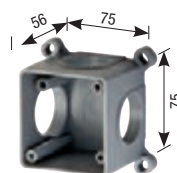

Art. 3188ME
Membrana isolante
Insulating membrane
Isolierungsmembran



Deviatore ceramico

Ceramic diverter

Keramik-Umstellventil

3 exits

1 entrata, 3 uscite, con OFF
1 entry, 3 exits and OFF position
1 Eingang, 3 Ausgänge mit OFF



Diagramma di portata (uscita libera)

Flow diagram (free exit)

Diagramm der Durchflussleistung (freier Ausgang)

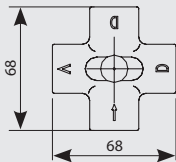
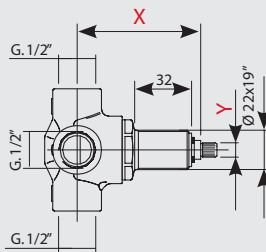
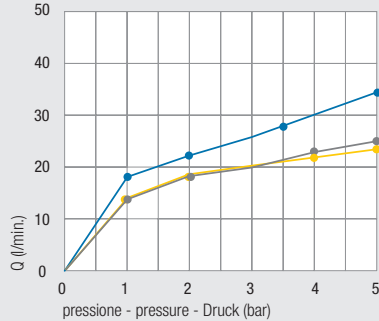

X	Y
72	BR. Ø 7,65 x Z=20 BR. Ø 8 x Z=24
83,5	BR. Ø 7,65 x Z=20 BR. Ø 8 x Z=24
92	BR. Ø 7,65 x Z=20 BR. Ø 8 x Z=24
112,5	BR. Ø 7,65 x Z=20 BR. Ø 8 x Z=24

Gebis
water control

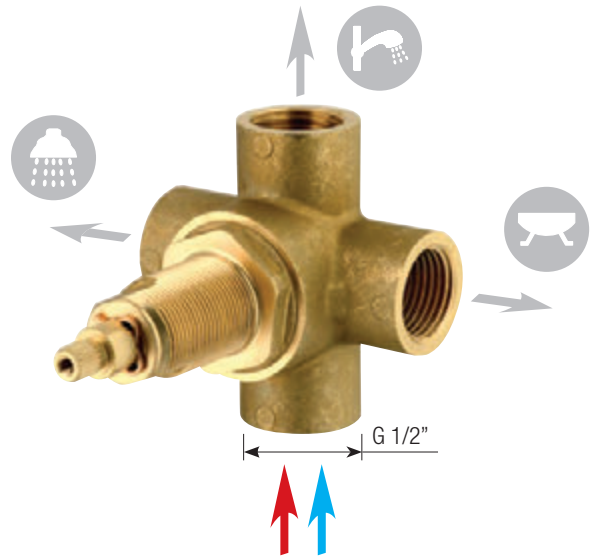

NPT
Available

Art. 2209

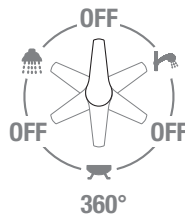

Art. 2209CA

CON alette di fissaggio
WITH fixing system
MIT Befestigungsrippen

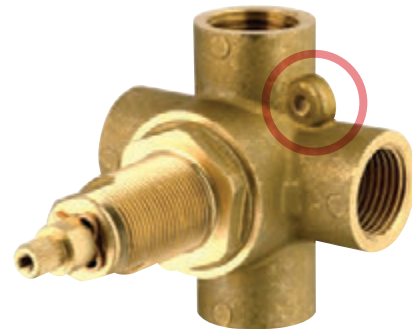

INSTALLATION Art. 3188 page 150 - Art. 3190 page 152

Adattatore
Ring adaptor
Adapter
Art. 2501 A Ø 26X19"
Art. 2502 A Ø 27X19"
Art. 2504 A G.3/4"



Art. 00080ROS
Rosoni h 2 mm
Rosas h 2mm
Rosas h 2 mm

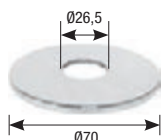

Art. 3181G1/2
Guarnizione G.1/2"
Gasket G.1/2"
Dichtung mit 1/2"-Drehung



Art. PR22/19
Protezione coprifiletto
Thread protection
Gewindeabdeckungsschutz

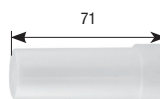

Deviatore ceramico

Ceramic diverter

Keramik-Umstellventil



Diagramma di portata
(uscita libera)

Flow diagram
(free exit)

Diagramm der
Durchflussleistung
(freier Ausgang)

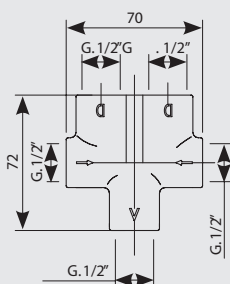
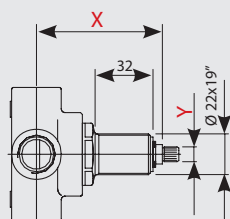
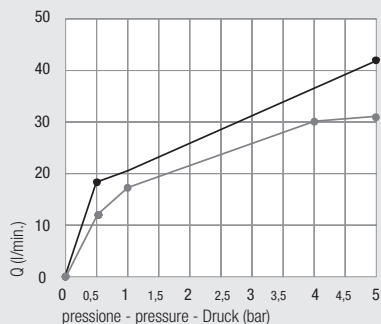

X	Y
72	BR. Ø 7,65 x Z=20 BR. Ø 8 x Z=24
83,5	BR. Ø 7,65 x Z=20 BR. Ø 8 x Z=24
92	BR. Ø 7,65 x Z=20 BR. Ø 8 x Z=24
112,5	BR. Ø 7,65 x Z=20 BR. Ø 8 x Z=24

Gebis
water control

3
exits

2 entrate, 3 uscite

2 entries, 3 exits

2 Eingänge, 3 Ausgänge

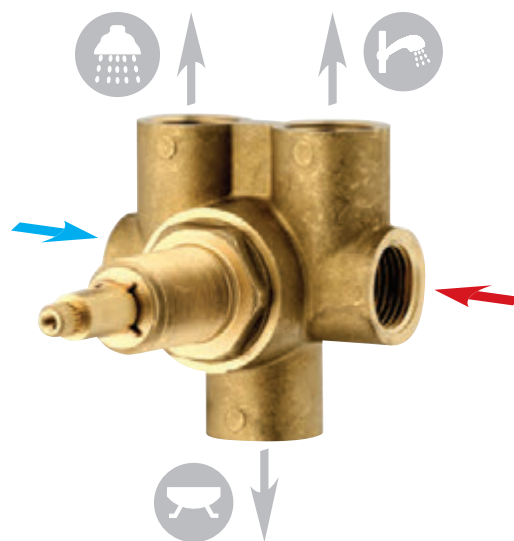

Art. 2310

CON economizzatore
WITH saving function
MIT Economiser

Art. 2309

SOLO deviatore
diverter ONLY
NUR Umstellventil

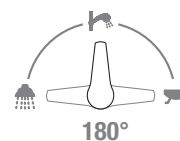
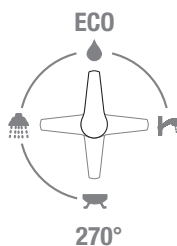

Art. 00120
Maniglia deviatore
Diverter handle
Umstellgriff



Art. 00080
Coprifiletto deviatore cromato
Diverter cover thread
Verchromte Gewindeabdeckung
für das Umstellventil

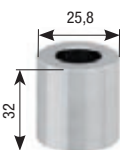

Art. 00080ROS
Rosoni h 2 mm
Rosas h 2 mm
Rosas h 2 mm

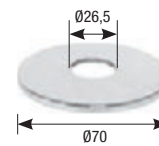

Adattatore
Ring adaptor
Adapter

Art. 2501 A Ø 26X19"
Art. 2502 A Ø 27X19"
Art. 2504 A G.3/4"



Art. PR22/19
Protezione coprifiletto
Thread protection
Gewindeabdeckungsschutz

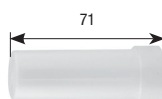

Deviatore ceramico

Ceramic diverter

Keramik-Umstellventil

4 exits

1 entrata, 4 uscite
1 entry, 4 exits
1 Eingang, 4 Ausgänge

Diagramma di portata
(uscita libera)

Flow diagram
(free exit)

Diagramm der
Durchflussleistung
(freier Ausgang)

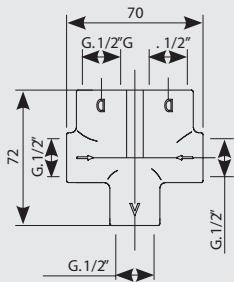
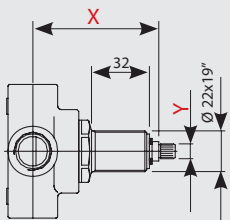
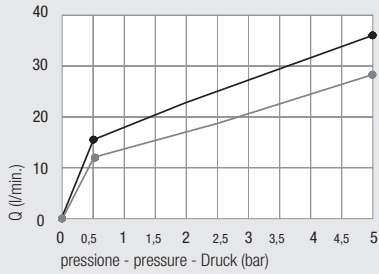

X **Y**

72	BR. Ø 7,65 x Z=20 BR. Ø 8 x Z=24
83,5	BR. Ø 7,65 x Z=20 BR. Ø 8 x Z=24
92	BR. Ø 7,65 x Z=20 BR. Ø 8 x Z=24
112,5	BR. Ø 7,65 x Z=20 BR. Ø 8 x Z=24

Gebis
water control

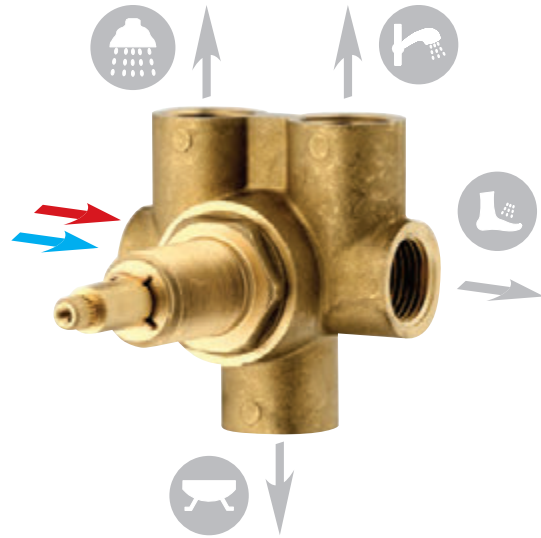

Art. 2320

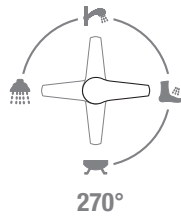

Art. 2320 SF

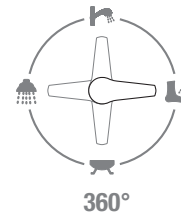

Art. 2330

con 2 OFF
with 2 OFF positions
mit 2 OFF

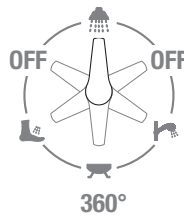

Deviatore ceramico

Ceramic diverter

Keramik-Umstellventil



Diagramma di portata
(uscita libera)

Flow diagram
(free exit)

Diagramm der
Durchflussleistung
(freier Ausgang)

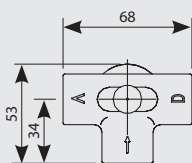
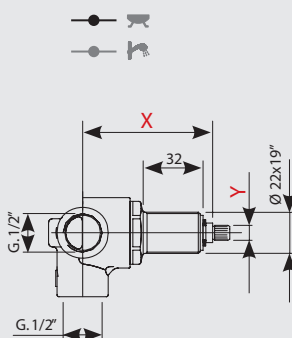
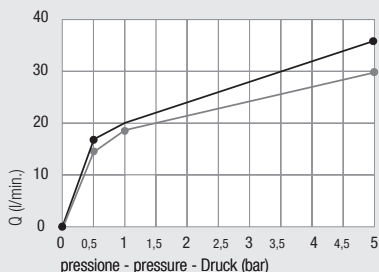

X	Y
72	BR. Ø 7,65 x Z=20 BR. Ø 8 x Z=24
83,5	BR. Ø 7,65 x Z=20 BR. Ø 8 x Z=24
92	BR. Ø 7,65 x Z=20 BR. Ø 8 x Z=24
112,5	BR. Ø 7,65 x Z=20 BR. Ø 8 x Z=24

Gebis
water control

2 exits

1 entrata, 2 uscite con OFF
1 entry, 2 exits with OFF position
1 Eingang, 2 Ausgänge mit OFF

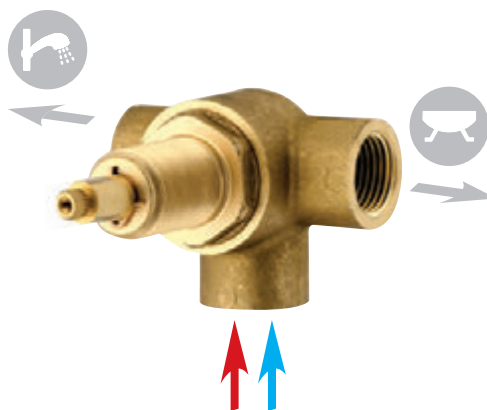

NPT
Available

Art. 2205

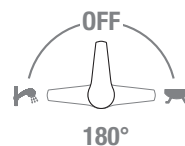

Art. 2205 SF

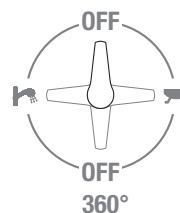

Art. 2205/90

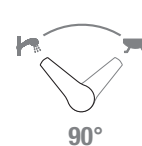

Art. 2205CA

Art. 2205CA SF

Art. 2205CA/90

CON alette di fissaggio
WITH fixing system
MIT Befestigungsrippen



INSTALLATION Art. 3188 page 150 - Art. 3190 page 152

Art. 00120
Maniglia deviatore
Diverter handle
Umstellgriff

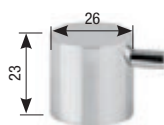

Art. 3188
Scatola di assemblaggio
Multipurpose assembling box
Montagegehäuse

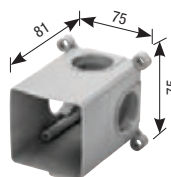

Art. 3189
Plastra copriscatola
Box cover plate
Abdeckplatte des Kastens



Art. 00080
Coprifiletto deviatore cromato
Diverter cover thread
Verchromte Gewindeabdeckung
für das Umstellventil

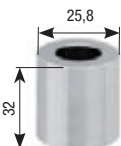

Art. 3190
Scatola di assemblaggio
Multipurpose assembling box
Montagegehäuse

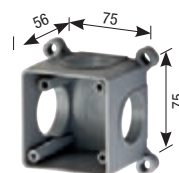

Art. 3188ME
Membrana isolante
Insulating membrane
Isolierungsmembran



Deviatore ceramico

Ceramic diverter

Keramik-Umstellventil

2
exits

1 entrata, 2 uscite
1 entry, 2 exits
1 Eingang, 2 Ausgänge

DZR
Available

ACS

WRAS

KTW

Diagramma di portata
(uscita libera)

Flow diagram
(free exit)

Diagramm der
Durchflussleistung
(freier Ausgang)

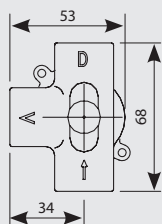
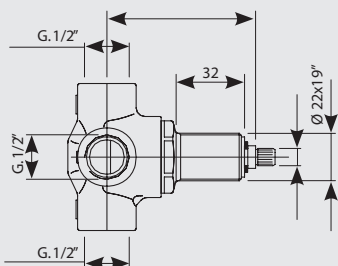
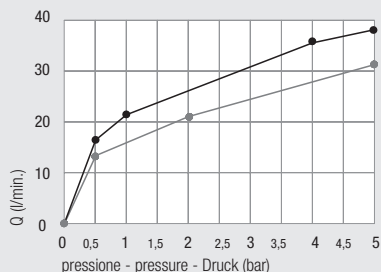

X **Y**

72	BR. Ø 7,65 x Z=20 BR. Ø 8 x Z=24
83,5	BR. Ø 7,65 x Z=20 BR. Ø 8 x Z=24
92	BR. Ø 7,65 x Z=20 BR. Ø 8 x Z=24
112,5	BR. Ø 7,65 x Z=20 BR. Ø 8 x Z=24

Gebis
water control

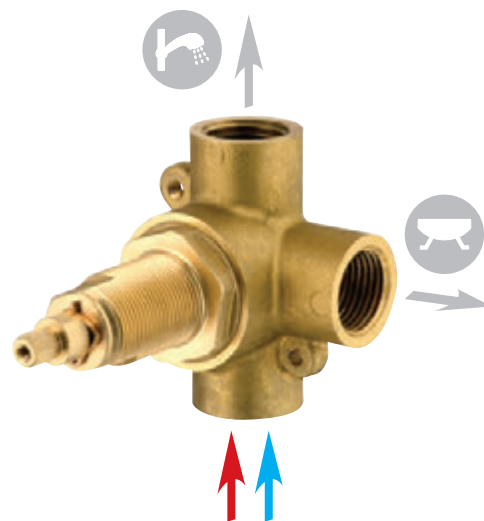

Art. 2207

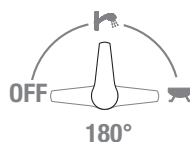

Art. 2207/90



Art. 2207/120

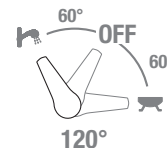

INSTALLATION Art. 3188 page 150 - Art. 3190 page 152

Adattatore
Ring adaptor
Adapter

Art. 2501 A Ø 26X19"
Art. 2502 A Ø 27X19"
Art. 2504 A G.3/4"



Art. 00080ROS
Rosoni h 2 mm
Rosas h 2mm
Rosas h 2 mm

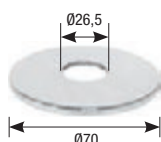

Art. 3181G1/2

Guarnizione G.1/2"
Gasket G.1/2"
Dichtung mit 1/2"-Drehung



Art. PR22/19

Protezione coprifiletto
Thread protection
Gewindeabdeckungsschutz



Art. 3188TAP

Tappo Ø 33 mm
Plug Ø 33 mm
Stopfen Ø 33 mm



Deviatore ceramico per pannello doccia

Ceramic *diverter* for shower panel

Keramik-Umstellventil für Duschpaneel

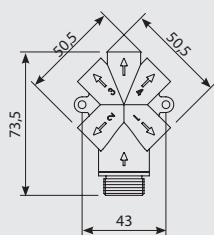
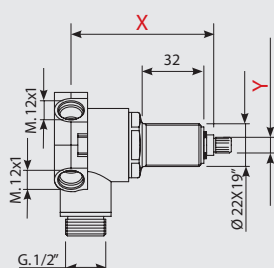
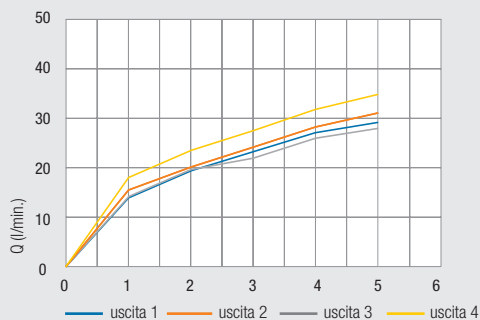

X	Y
72	BR. Ø 7,65 x Z=20 BR. Ø 8 x Z=24
83,5	BR. Ø 7,65 x Z=20 BR. Ø 8 x Z=24
92	BR. Ø 7,65 x Z=20 BR. Ø 8 x Z=24
112,5	BR. Ø 7,65 x Z=20 BR. Ø 8 x Z=24



Art. 5700R

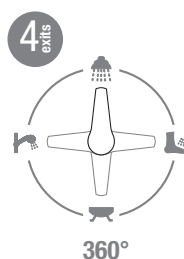

Art. 5700R/2

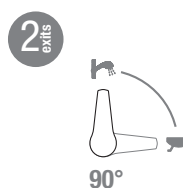

Art. 5700R/3

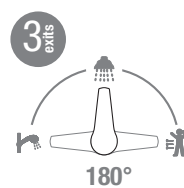

Art. 5700R/3 OFF

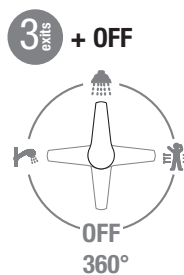

Art. 5700R/2 OFF SF

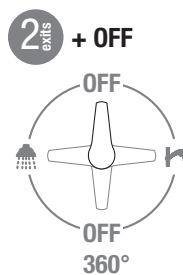

Art. 5710R

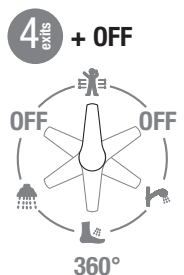

Art. 5710R/3 OFF

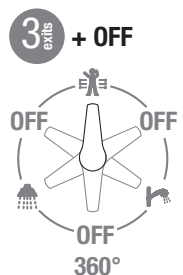

Art. 00120
Maniglia deviatore
Diverter handle
Umstellgriff

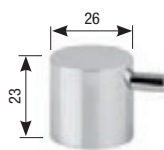

Art. 5700 PTG
Portagomma
Endhoser
Schlauchverbindung



Art. 5700 TAP
Tappo di chiusura
Closing plug
Verschlussstoptfen



Art. 00080
Coprifiletto deviatore cromato
Diverter cover thread
Verchromte Gewindeabdeckung
für das Umstellventil

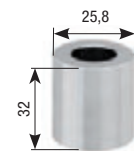

Adattatore **Art. 2501 A** Ø 26X19"
Ring adaptor **Art. 2502 A** Ø 27X19"
Adapter **Art. 2504 A** G.3/4"



Art. 00080ROS
Rosoni h 2 mm
Rosas h 2 mm
Rosas h 2 mm

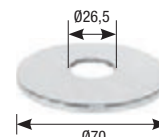

Art. 190
Innesto rapido
Fast connection
Schnellkupplung



Art. PR22/19
Protezione coprifiletto
Thread protection
Gewindeabdeckungsschutz



Deviatore ceramico

Ceramic diverter

Keramik-Umstellventil

5 exits

1 entrata, 5 uscite
1 entry, 5 exits
1 Eingang, 5 Ausgänge

Diagramma di portata (uscita libera)
Flow diagram (free exit)
Diagramm der Durchflussleistung (freier Ausgang)
Pressione massima suggerita
Max water pressure suggested
Maximal empfohlener betriebsdruck
3 bar (43,5 psi)

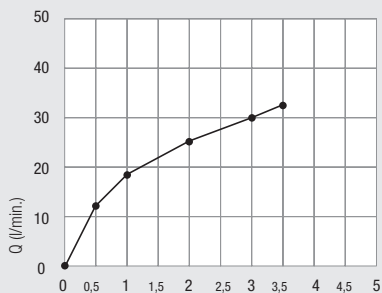

Art. 9200

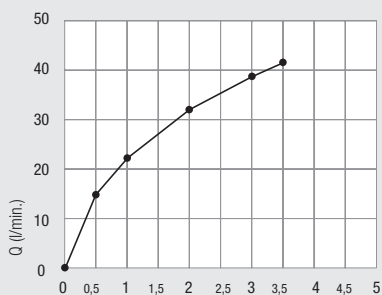

Art. 9100

● vasca - doccia - bocca - soffietti - soffione
bath - shower - spout - spray - showerhead
badewanne - dusche - auslauf - sprühköpfe - brausekopf

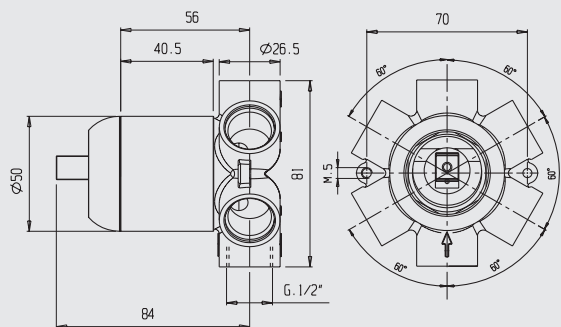

Gebis
water control

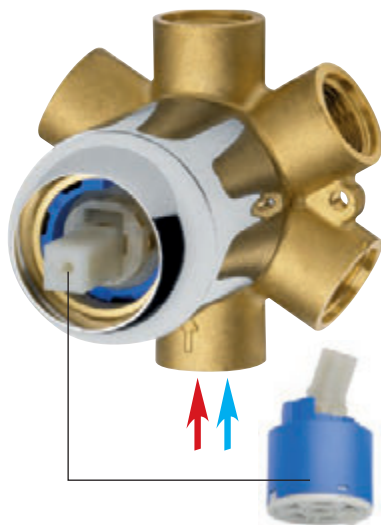

Art. 9200

OFF e regolatore di portata
OFF position and flow regulation
OFF und Durchflussregler

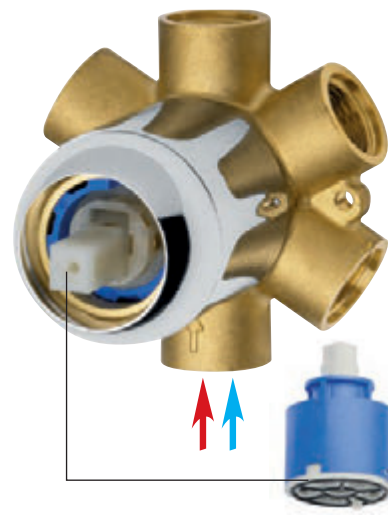

Art. 9100

deviatore
diverter
Umstellventil



Art. 9000

SOLO corpo deviatore
body diverter ONLY
NUR Umstellventil

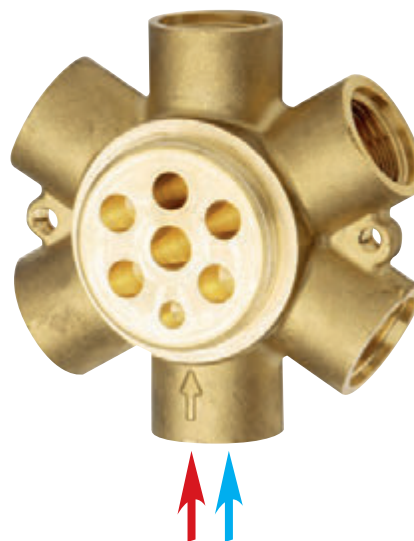

Art. 1161
Anello sede cartuccia
Cartridge ring seat
Kartuschenringsitz



Art. 1500
Cappuccio ABS
ABS cap
ABS-Kappe



Art. 1801
Ghiera serraggio
Ring nut
Gewindeverschraubung



Art. PR50
Protezione mix
Mix protection
Schutzvorrichtung Mixer



Art. 1501
Ghiera serraggio
Ring nut
Gewindeverschraubung



Possibili personalizzazioni

Possible customization

Möglichkeiten für kundenspezifische Ausführungen

